



27 Merola Way Campbellfield, VIC

## Excellent Investment Opportunity!

Looking for a strong return and the security of a long lease - Look No Further!

This high clearance, modern, 435 m2 (approx.) factory/warehouse with 2 level airconditioned offices, excellent amenities and 7 on site car spaces provides a perfect investment opportunity.

### Key Features:

- \* 3 year lease in place with 2 further terms of 3 years each.
- \* Leased at \$63,800.00 pa + Outgoings
- \* 4% Annual increases

### Key Points:

- \* Container Height, Electric Roller Door.
- \* 3 Phase Power
- \* Easy access to the Hume Highway and Cooper Street and Metropolitan Ring Road.

**Price:**

**SOLD: \$1,226,000**



**Branko Agatanovic Branko Agatanovic**

0448 035 565

0448 035 565

branko.a@lovere.com.au

branko.a@lovere.com.au

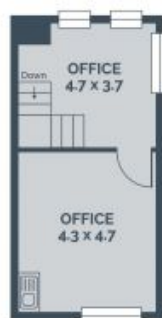

Car Space Not In Position	Car Space Not In Position	Car Space Not In Position	Car Space Not In Position	Car Space Not In Position	Car Space Not In Position
---------------------------------	---------------------------------	---------------------------------	---------------------------------	---------------------------------	---------------------------------

Every precaution has been taken to establish accuracy of the information in this brochure but does not constitute any representation by the vendor or agent.

LOVE & CO

LOVE & CO

27 Merola Way

Campbellfield, VIC