



6 Poppyfield Avenue Wollert, VIC



Luxurious Living in Every Detail

This grand property offers the epitome of opulent living, where no expense has been spared to create a home that exudes elegance, comfort, and timeless appeal. Nestled in a serene neighbourhood, this magnificent residence boasts a multitude of living zones to cater to your family's every need. Downstairs, a spacious bedroom, and bathroom provide the ideal setup for accommodating extended family, and the formal lounge, meals area, family room, and rumpus room offer versatility and abundant space. The heart of the home is the sprawling stone kitchen, complete with a walk-in pantry, which seamlessly connects to a beautiful alfresco area via glass bi-folded doors. Here, you can relish in watching your children play all year round while you unwind.

Property Features:

? Grand double timber door entrance that sets the tone for the entire home.

Price: \$1,110,000



Jim Kalakias

0402 177 336
jim.k@lovere.com.au



Ibby Zayat

0412 469 545
ibby.z@lovere.com.au

6 Poppyfield Avenue, Wollert

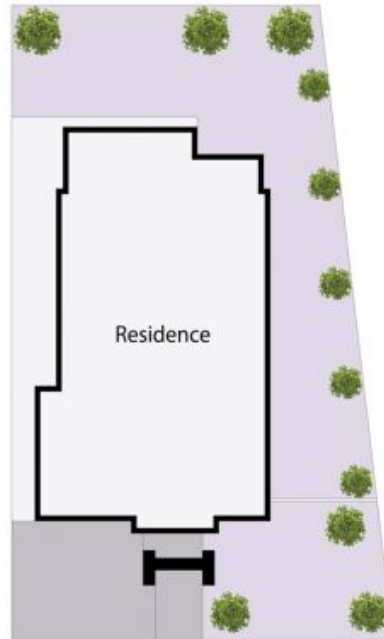

THE ABOVE PLAN IS AN ARTIST'S IMPRESSION ONLY, IT INCLUDES ELEMENTS THAT ARE FOR DISPLAY PURPOSES ONLY AND MAY NOT BE TO SCALE. LANDSCAPING SHOWN IS INDICATIVE ONLY. DIMENSIONS ARE APPROXIMATE.

