

2 Francis Walton Road Mill Park, VIC



### Complete Comfort. Absolute Convenience.

Spotless and spacious, this one-owner home sits on a generous allotment and offers relaxed family living in a relaxed family location.

Blending perfect position and proportions, Mill Park Heights Primary and the bus are just around the corner, whilst The Stables, South Morang Station and Westfield are all within easy reach.

With freshly polished timber floors underfoot, the home features formal living zone under cathedral ceiling, a solid timber kitchen overlooking a generous meals/family space, three-bedroom and two bathrooms.

Rounding out the perfect package is a huge double garage with drive-through access to a sensational rear yard with paved and grassy areas of equal proportion.

**Price:** Sold \$878,000

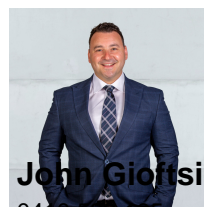

**John Giotsidis**

0416 522 195  
john.g@lovere.com.au

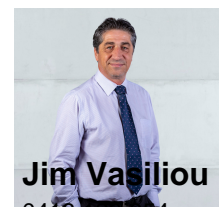

**Jim Vasiliou**

0418 123 634  
jim.v@lovere.com.au

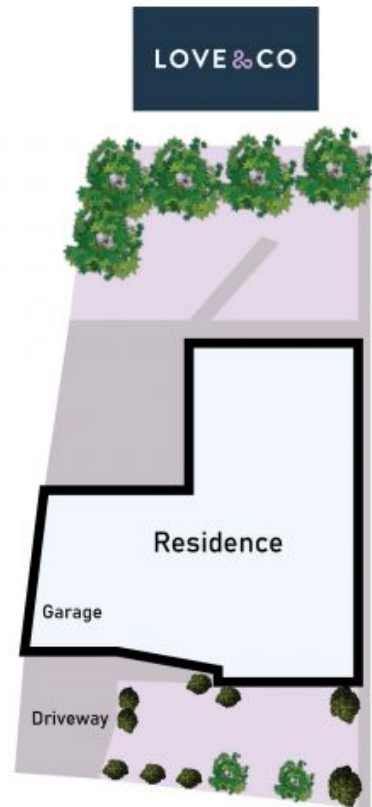
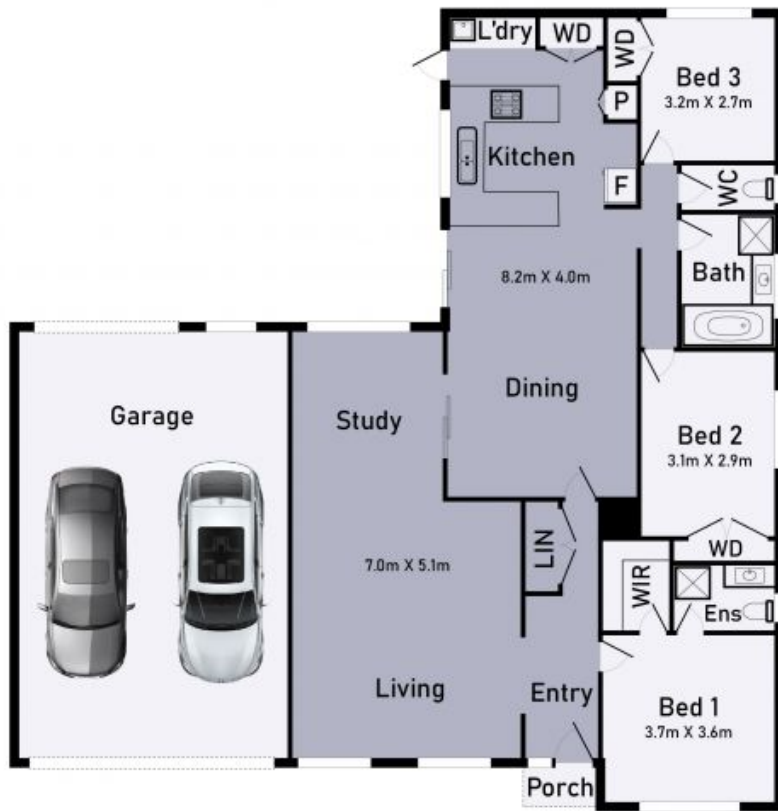

## 2 Francis Walton Road Mill Park

\* Dimensions are approximate and for illustrative purposes only



**LOVE & CO**

2 Francis Walton Road

Mill Park, VIC