



11 Mahon Road Epping, VIC



### Find Your Happy Place

This property presents a fantastic opportunity for first-time homebuyers, investors, or those looking to downsize. The open-plan living area seamlessly integrates with a generously sized kitchen, complete with stainless steel appliances. Both bedrooms offer ample space and are equipped with built-in robes for convenient storage. The low-maintenance paved courtyard is perfect for relaxation and includes a handy shed. Situated within close proximity to two major shopping hubs, Epping Plaza and Westfield Plenty Valley along with schools and parks.

- ? Open-plan living with a spacious kitchen and stainless steel appliances
- ? Two generously sized bedrooms with built-in robes
- ? Low-maintenance paved courtyard with a storage shed
- ? Split system for heating and cooling
- ? Convenient dishwasher included
- ? Elegant tile flooring in living areas
- ? Downlights

**Price:** \$420,000



**Jim Kalakias**

0402 177 336  
jim.k@lovere.com.au



**Ibbby Zayat**

0412 469 545  
ibby.z@lovere.com.au

# 11 Mahon Road, Epping

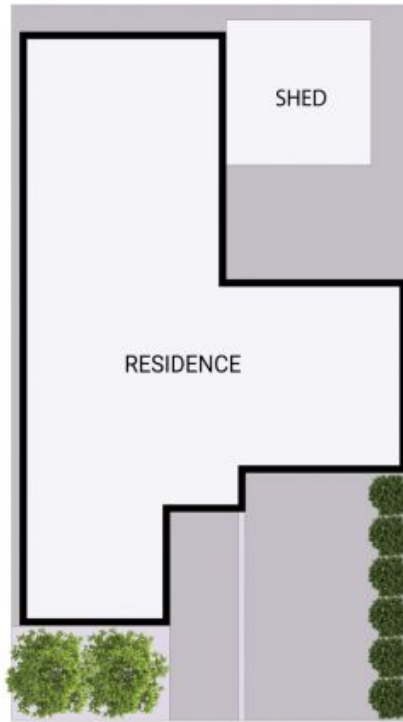

THE ABOVE PLAN IS AN ARTIST'S IMPRESSION ONLY, IT INCLUDES ELEMENTS THAT ARE FOR DISPLAY PURPOSES ONLY AND MAY NOT BE TO SCALE. LANDSCAPING SHOWN IS INDICATIVE ONLY. DIMENSIONS ARE APPROXIMATE.

