



52 Loudon Circuit Craigieburn, VIC



### Style Meets Comfort

Nestled within the sought-after Highlands Estate, this exquisite property is a captivating blend of modern luxury and timeless charm. Whether you're a first-time homebuyer embarking on a new journey, a downsizer seeking elegance and ease, or an astute investor looking for a gem, this home is your canvas for a vibrant future.

As you step inside, you'll be greeted by an ambiance of warmth and sophistication. The master bedroom boasts an ensuite and a walk-in robe, offering a private sanctuary for relaxation. Two additional bedrooms, adorned with built-in robes, are thoughtfully serviced by a central bathroom, providing comfort and convenience for all.

The heart of this home is the open-plan living area, where natural light dances through large windows, creating an inviting space for family gatherings and entertaining friends. The kitchen is a masterpiece, featuring stainless steel appliances, a 900mm oven, a dishwasher, and stone benchtops ? an epicurean's dream come true.

**Price:** \$557,500



**Jim Kalakias**

0402 177 336  
jim.k@lovere.com.au



**Ibbby Zayat**

0412 469 545  
ibby.z@lovere.com.au

# 52 Loudon Circuit, Craigieburn

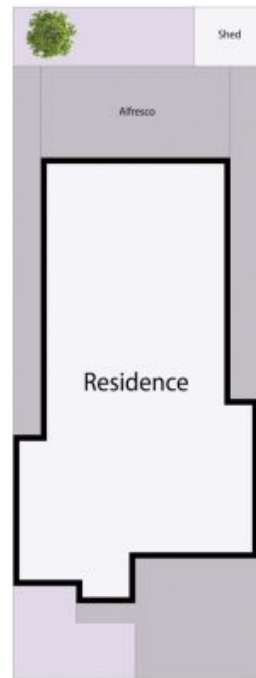

THE ABOVE PLAN IS AN ARTIST'S IMPRESSION ONLY, IT INCLUDES ELEMENTS THAT ARE FOR DISPLAY PURPOSES ONLY AND MAY NOT BE TO SCALE. LANDSCAPING SHOWN IS INDICATIVE ONLY. DIMENSIONS ARE APPROXIMATE.

