



22 Greenview Court Epping, VIC

3

1

5

As Good As Brand New

UNDER CONTRACT

Price: Sold \$661,000

With its stylish renovation recently completed, move straight into this modern three-bedroom single-level home and enjoy an essentially brand-new living experience in a desirable family-oriented pocket.

Generously proportioned on a fantastic 512sqm (approx.) block on the footsteps of Greenview Court Park, downsizing buyers still have loads of space to entertain the grandkids, while the young couple with an eye on the future have plenty of room for growth here!

Fully renovated with an eye for style and focus on quality, there's comfort in the knowledge there's not a single task that requires your attention, which translates into you spending more time entertaining friends in the huge outdoor entertaining area or sampling the gourmet eateries at nearby Westfield Plenty Valley or Epping Plaza's buzzing dining precinct.

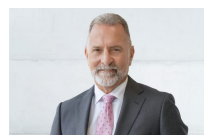

Roger Pettinella

0418 588 419
roger.p@lovere.com.au



John Gioftsidis

0410 522 195
john.g@lovere.com.au

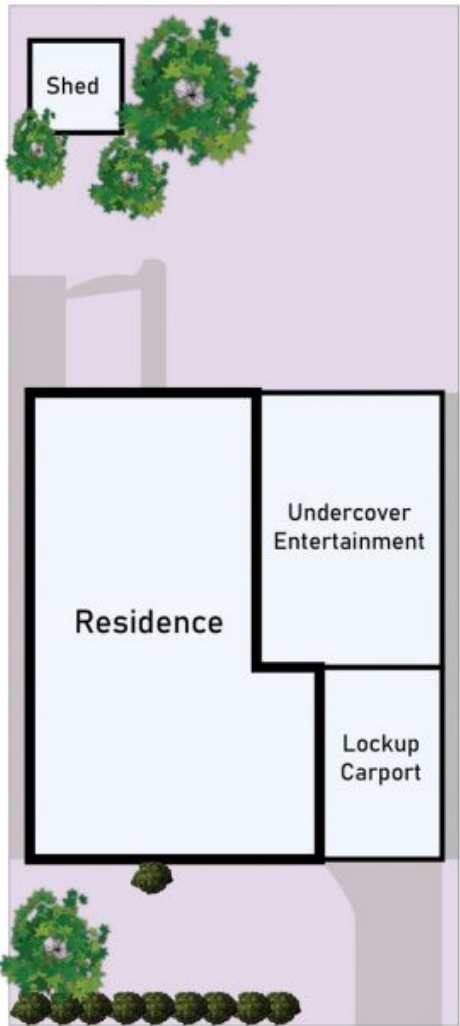
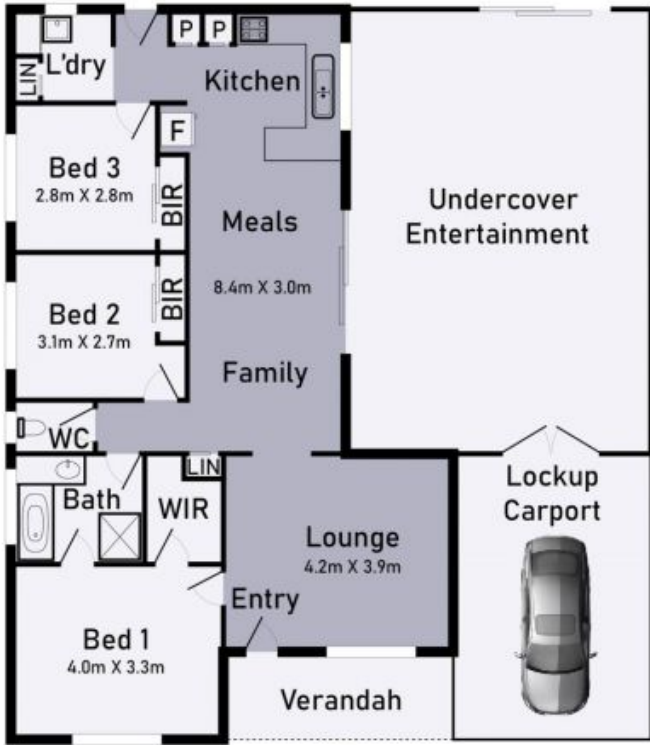

22 Greenview Court Epping

* Dimensions are approximate and for illustrative purposes only

