



5 Hallmark Close Mill Park, VIC



Parkside Family Living With Potential

Growing families take note - this three-bedroom residence with a fully self-contained two-bedroom studio and soothing views across neighbouring Statesment Crescent Playground offers all the room you will ever need!

Position-perfect at the top of a quiet court in a popular family-friendly pocket, this bright and spacious home that's ideal for first-time buyers, the young family and investors represents an affordable upgrade in space and lifestyle with its two separate living areas, zoned accommodation, two bathrooms, relaxed outdoor entertaining.

Light and space are hallmarks of the warm and welcoming L-shaped living/dining area on entry, while polished timber floorboards, high ceilings and plentiful natural light work to extend the feeling of spaciousness throughout the large open-plan living, overseen by a modern family-sized kitchen.

Price: Sold



John Giotsidis

0416 522 195
john.g@lovere.com.au

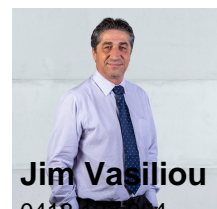

Jim Vasiliou

0418 123 634
jim.v@lovere.com.au

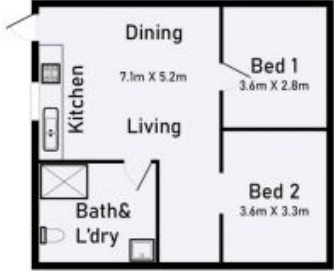
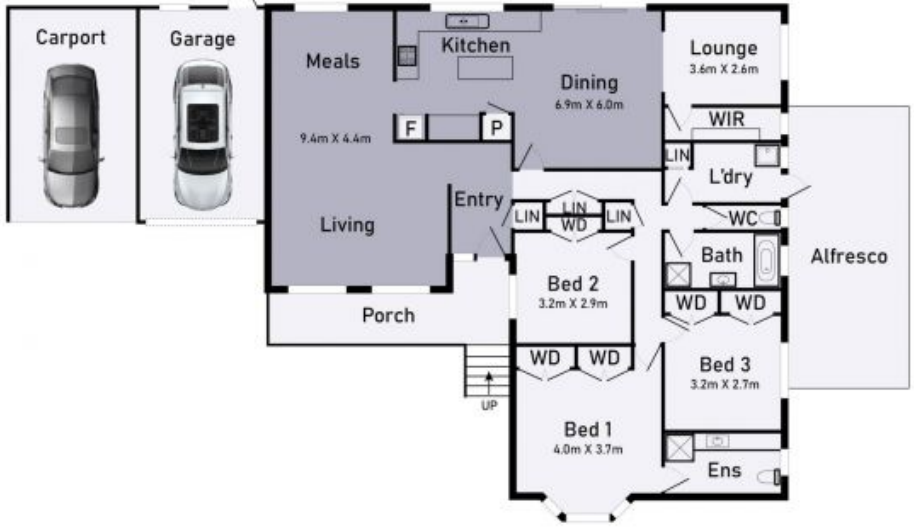

5 Hallmark Close Mill Park

* Dimensions are approximate and for illustrative purposes only

