



1 Newton Crescent Lalor, VIC

3 1 4

### A PIECE OF HISTORY (land size 731m2)

Presenting a charming facade from the bygone era this classic period home promises great rewards and immense value adding possibilities. whether you're a young couple/family wanting to break into the market or a savvy investor looking to make your mark, this attractive family home is a opportunity not to be missed.

A substantial size allotment totaling 731m2 and a nicely landscaped front garden and porch greet you on arrival.

The home comprises, formal lounge, 3 good size bedrooms, updated kitchen overlooking spacious meals area, single lock up garage and a generous size rear yard.

Above all, this home is only minutes walk to station street shops, Lalor train station, Medical centres, high schools, primary schools, outdoor recreational centres and much more.

Don't miss your opportunity to capitalise on this great address.

**Price:** Sold \$765,000



**Jim Vasiliou**

0418 123 034  
jim.v@lovere.com.au

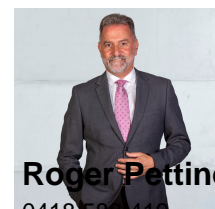

**Roger Pettinella**

0418 588 419  
roger.p@lovere.com.au

LOVE & CO

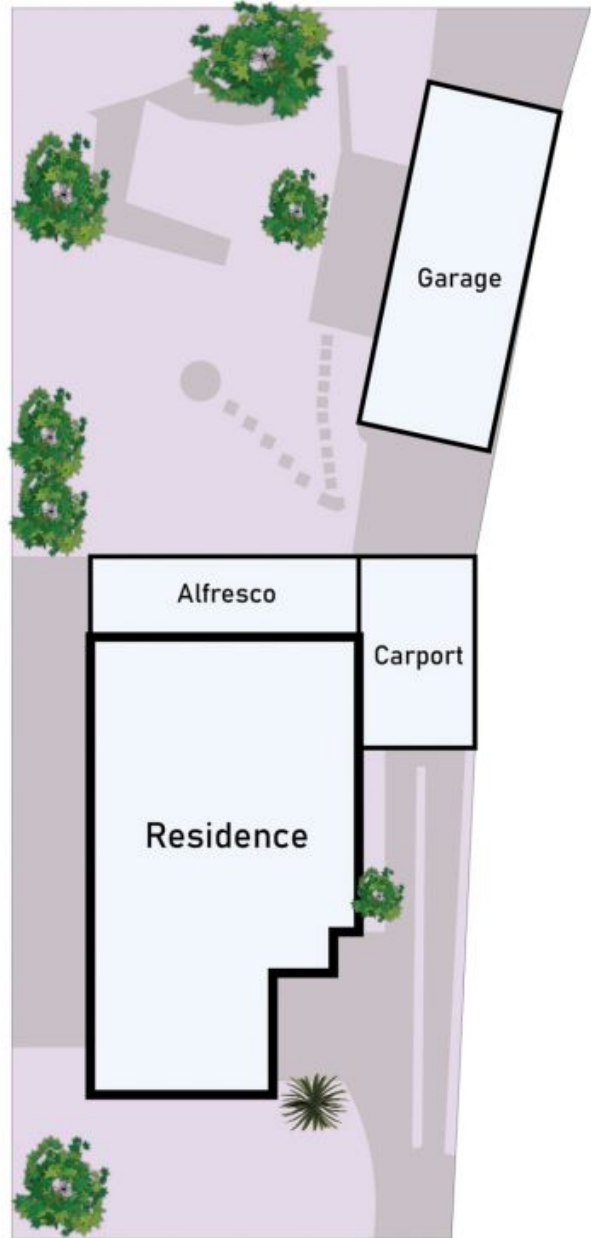
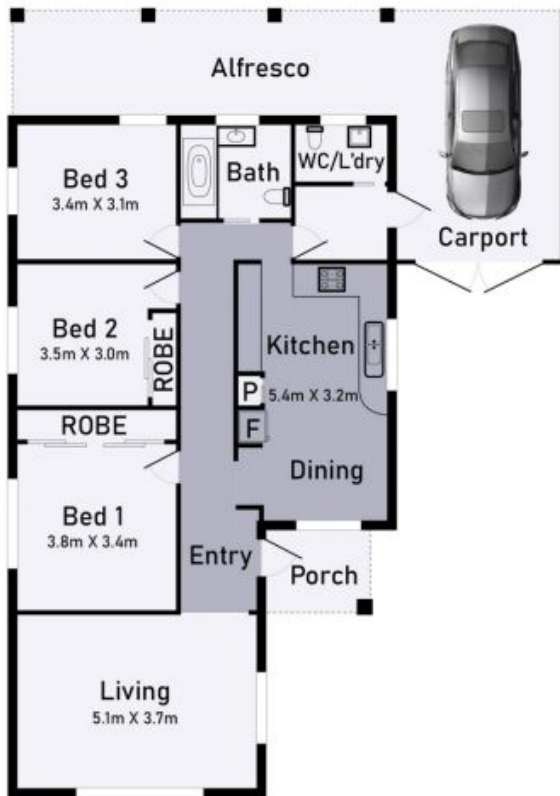
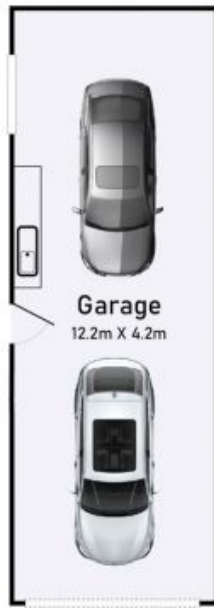

## 1 Newton Crescent Lalor

\* Dimensions are approximate and for illustrative purposes only

1 Newton Crescent

Lalor, VIC

LOVE & CO

