



2/17 Prince Andrew Avenue Lalor, VIC

 3
  2
  2

### 3 BEDROOMS, 2 BATHROOMS - WALK TO EVERYTHING

With only 2 on the block, this fabulous single level unit/home offers low maintenance living at its best and presents a fantastic step into the property market for first home buyers, young families, a superb downsizing opportunity or a great addition to an investment portfolio.

Perfectly positioned in a very desirable lifestyle location, within walking distance to Lalor Train Station, around the corner from Rochdale Square shops, recreational parks, sporting facilities, only minutes to the vibrant Station St shops, schools, COSTCO, Pacific Plaza Epping, Northern Hospital and easy access to major road arterials.

Contemporary in design, this beautifully presented home showcases a spacious, light filled interior complimented by a relaxed sophistication and a warm, homely ambience that flows throughout.

Additional features include

**Price:** Auction Saturday 8th July at 12:30pm



**Ryan Di Natale**  
0418 330 587  
ryan.d@lovere.com.au

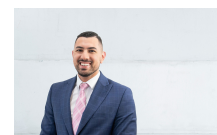

**Jude Kattan**  
0450 848 255  
jude.k@lovere.com.au

# 2/17 Prince Andrew Avenue, Lalor

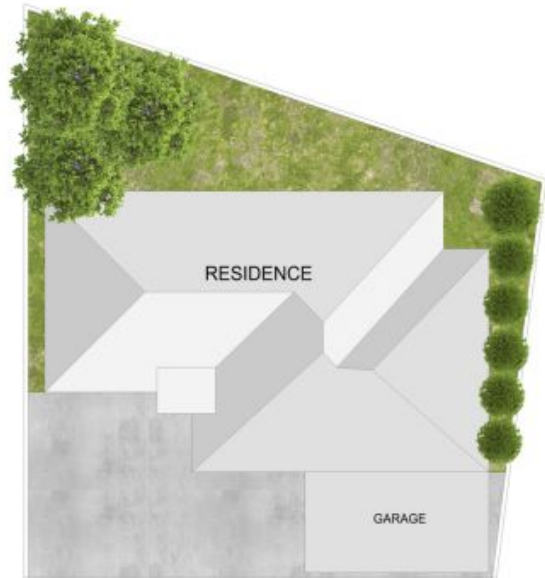

THE ABOVE PLAN IS AN ARTIST'S IMPRESSION ONLY, IT INCLUDES ELEMENTS THAT ARE FOR DISPLAY PURPOSES ONLY AND MAY NOT BE TO SCALE. LANDSCAPING SHOWN IS INDICATIVE ONLY. DIMENSIONS ARE APPROXIMATE.

**LOVE & CO**

2/17 Prince Andrew Avenue

Lalor, VIC