



6/6 Campbell Street Epping, VIC

 2
  1
  1

A Brilliant Blend Of Lifestyle And Location

This generously proportioned home, a 300 m walk to the station, a short stroll to the culinary delights of High Street and an easy walk to Epping Plaza for shopping, a meal, and a movie, brilliantly blends lifestyle and location with low-maintenance ease.

Complementing the spacious lounge with a garden outlook, the family meals, overlooked by the kitchen, extend out to a peaceful and private covered entertainment area perfect for all-weather relaxation and alfresco enjoyment.

Two bedrooms, both with carpet and built-in robes, complete a package perfect for those starting out, slowing down or looking to take advantage of today's rewarding rental returns!

? Engineered timber floors to living areas

Price: \$480,000



Jim Kalakias

0402 177 336

jim.k@lovere.com.au

6/6 Campbell Street, Epping

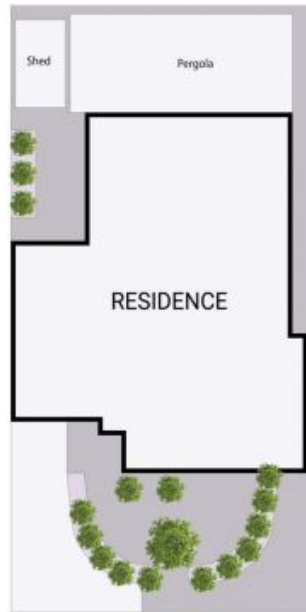

THE ABOVE PLAN IS AN ARTIST'S IMPRESSION ONLY, IT INCLUDES ELEMENTS THAT ARE FOR DISPLAY PURPOSES ONLY AND MAY NOT BE TO SCALE. LANDSCAPING SHOWN IS INDICATIVE ONLY. DIMENSIONS ARE APPROXIMATE.

