



5 Silverthorn Court Mill Park, VIC

 4
  2
  3

Impressive In Every Respect

Indulge yourself with a captivating mix of detailed quality, sunfilled living zones and faultless presentation. Defined by its strong contemporary appeal, this home delivers a wonderful family lifestyle in a "Blue-Ribbon" court location. Features a formal lounge, stunning Gloss Wrap kitchen with family-size bench spaces overlooking the meals area. 4 Bedrooms (Mast: Ensuite), a beautiful family bathroom and a 2nd family/rumpus area, framed by windows and bathed in natural light. Heating and Cooling throughout, plus a picture-perfect landscaped rear yard with a BBQ area, child-friendly play area and a drive-thru garage. Add to this, a stunning undercover multi-vehicle carport/alfresco area with a built-in bar and remote controlled security shutters creating an "all year" work and/or entertainment zone. With Mill Park Heights Primary School, the Stables S/Centre, Mill Park Leisure Centre and Parklands just moments away. Simply you must inspect to appreciate all the included features inside & out. Just step in, and let the romance begin.

Price: Sold \$840,000

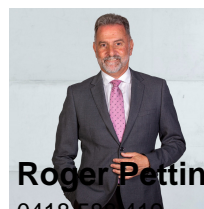

Roger Pettinella
0418 588 419
roger.p@lovere.com.au



John Gioltsidis
0416 522 195
john.g@lovere.com.au

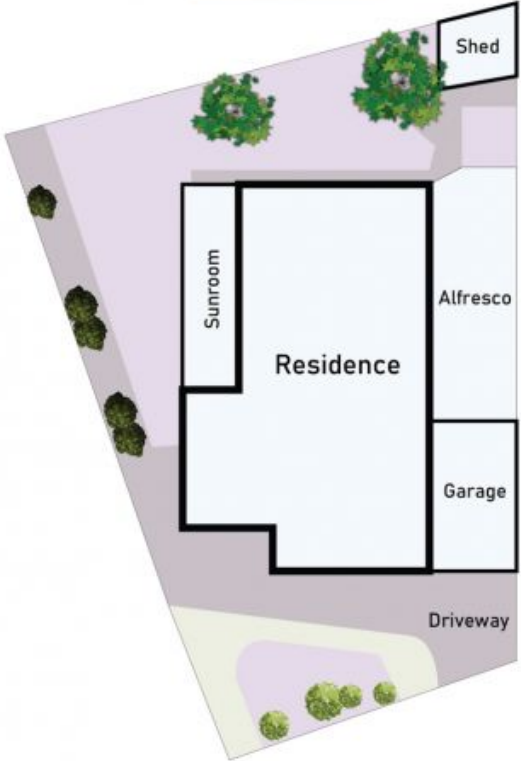

5 Silverthorn Court, Mill Park

* Dimensions are approximate and for illustrative purposes only

