



152-162 Campbell Street Swan Hill, VIC

PROMINENT MEDICAL CENTRE IN THE HEART OF SWAN HILL

Perfectly positioned with dual 50 meter street frontage and exposure to Swan Hills busiest intersection amongst Woolworths, major banks etc. This space is ready to use with the existing fit out and start immediately or upgrade to start fresh and create your own space.

- Well-presented 480 sqm (approx.)
- Exceptionally well-planned floor plan fitted out with cabinetry and desks
- Generous customer car parking
- Zoned Commercial 1
- Open reception and treatment room
- Fifteen spacious consultation rooms
- Suitable to a variety of users including - GP, Specialist, Allied Health, Radiology, Physiotherapist or Pharmacy

Price: Contact Agent

Council Rates: \$0.00 p/q

Water Rates: \$0.00 p/q

Strata Rates: \$0.00 p/q



Lucy McMahon

lucy.m@lovere.com.au

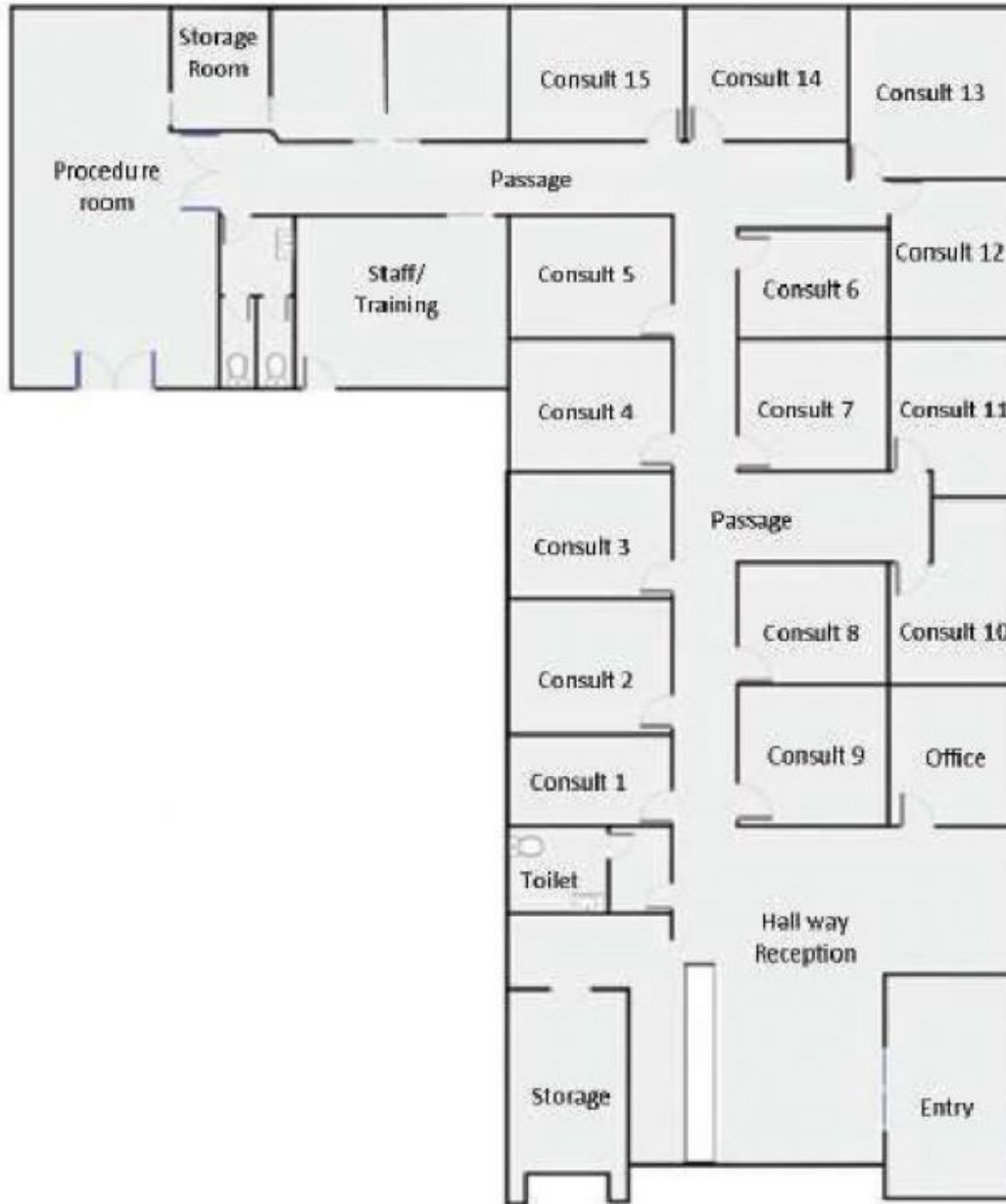

Note floor plan is approximate and for illustration purposes only