



3/7 Dorothy Avenue Thomastown, VIC



2



1



1

PERFECT START - 150m TO THE TRAIN STATION

Whether you are a first home buyer wanting to get into the property market or an astute investor looking for a solid investment, here is an outstanding opportunity to secure this quality built, fabulous townhouse, superbly located in a prime location, with the absolute convenience of having everything you need literally at your doorstep.

Step outside and a world of convenience awaits. Just metres to Thomastown train station, bus routes, High St strip shopping, cafes, eateries, the vibrant Station/ May Rd shopping precinct, local schools, only minutes to Pacific Plaza Epping, COSTCO, Health Services and easy access to major road arterials and the Ring Road Network.

Cleverly designed for modern day living, this surprisingly, spacious home comprises open plan living, stone finished kitchen with stylish cabinetry, stainless steel appliances, 900mm gas cooktop/electric oven, dishwasher, meals/ dining area and Euro style laundry with powder room facilities.

Price:

SOLD \$453,000

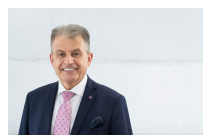

Ilia Menkinoski

0417 528 100

ilia.m@lovere.com.au



Ilia Menkinoski

0417 528 100

ilia.m@lovere.com.au

3/7 Dorothy Avenue, Thomastown

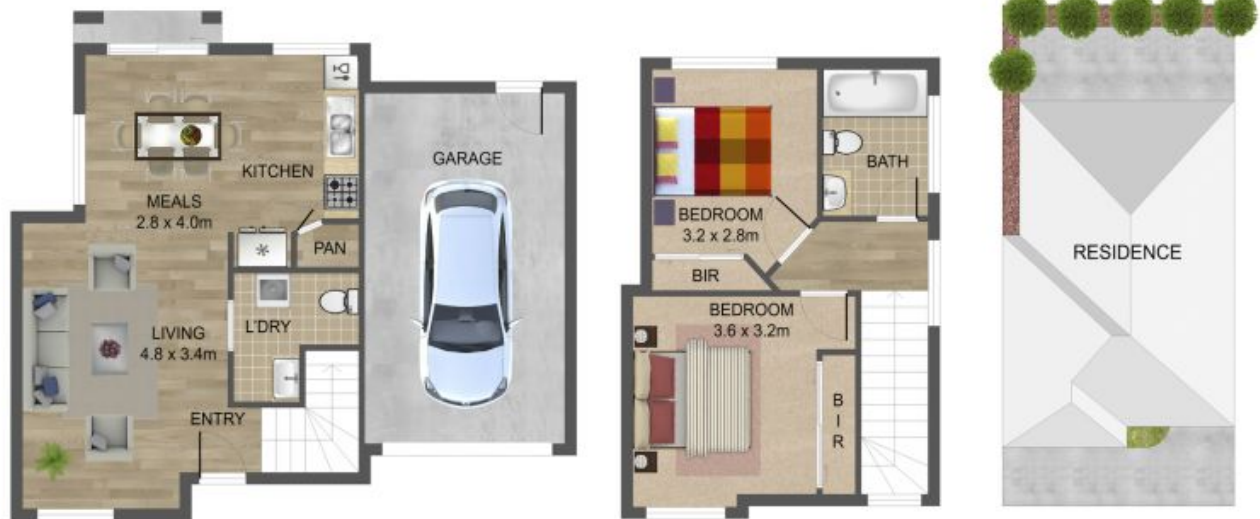

THE ABOVE PLAN IS AN ARTIST'S IMPRESSION ONLY, IT INCLUDES ELEMENTS THAT ARE FOR DISPLAY PURPOSES ONLY AND MAY NOT BE TO SCALE. LANDSCAPING SHOWN IS INDICATIVE ONLY. DIMENSIONS ARE APPROXIMATE.

LOVE & CO

3/7 Dorothy Avenue

Thomastown, VIC