



2 Shearer Court Mill Park, VIC



Tidy me up ? then watch me glow !!!!!

Auction This Saturday @ 11.30am

Price: Sold \$705,000

Awash with exceptional potential and in need of some TLC, this much loved family home is just perfect for smart buyers with a vision.

Right on the fringe of "Blue-Ribbon " Mill Park Heights, this spacious home features a formal lounge, sep dining area, 2nd family/rumpus area and a timber kitchen with meals area. Upstairs comprises 4 extra-large Bedrooms (Mast:ENS/WIR), a retreat area and more . Add to all this, ducted heating/evaporative cooling, 2 bathrooms, 3 toilets, oversize double garage with new door, timber decked entertainment area and more?

What an outstanding affordable opportunity for families looking to further enhance this home or a magnificent 600m2 new home site (STCA) in a superb court location.

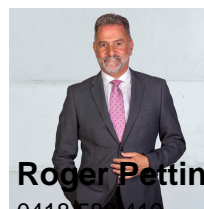

**Roger Pettinella**  
0418 588 419  
roger.p@lovere.com.au



**Nick Kandi**  
0412 310 704  
nick.k@lovere.com.au

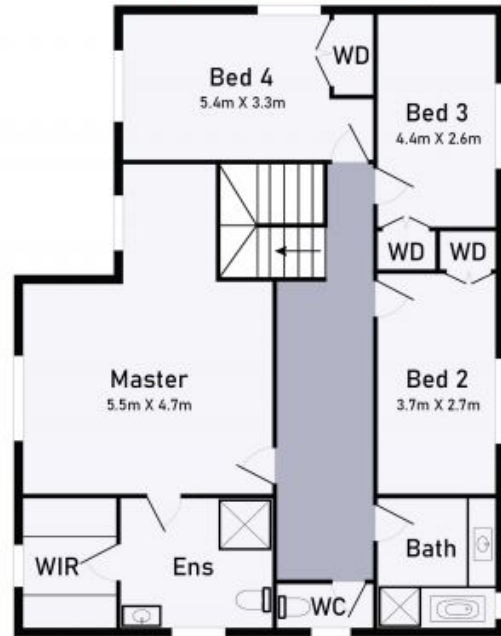
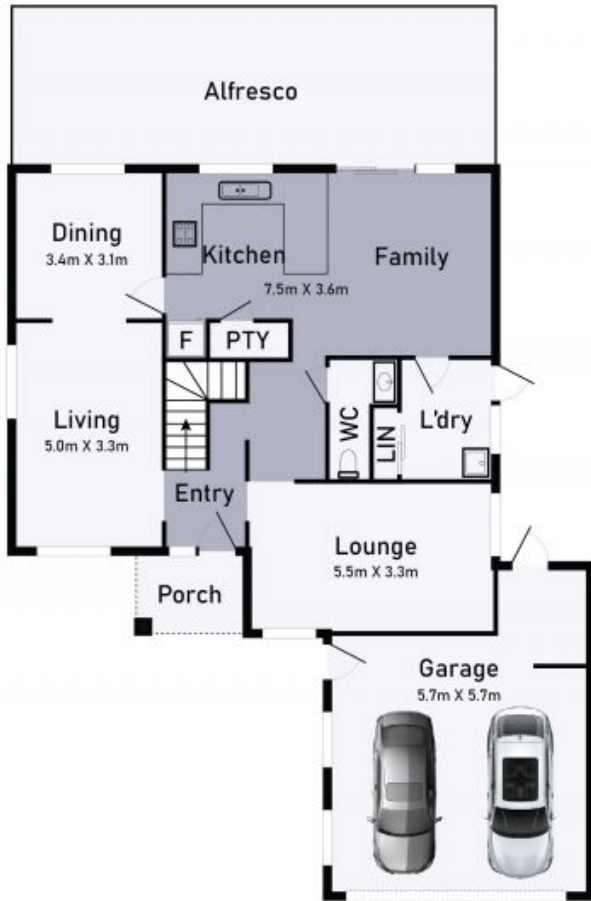

## 2 Shearer Ct Mill Park

\* Dimensions are approximate and for illustrative purposes only