



48 Caroline Street Clifton Hill, VIC

 2
  1
  1

Treasure-trove Of Possibilities

A treasure-trove of possibilities steps to Quarries Park, this spacious two bedroom home is a rare discovery of unparalleled potential offered for the first time in over 60 years. On a coveted 283m2 corner allotment with a large north-facing rear garden, this immediately comfortable home comprising spacious living, dining and a spotless eat-in kitchen, with heating/cooling and garage large enough to include a workshop stands ready for renovation/redevelopment to transform it into the pride of the street, STCA.

- ? Lofty ceilings and grandly proportioned rooms throughout
- ? Free-flowing living & dining rooms, retro eat-in kitchen
- ? Central bathroom, heating/cooling and garage/workshop
- ? Park side location near Quarries Park & Merri Creek trails
- ? Walk to Spensley St Primary, cafes & Clifton Hill Station
- ? Unrivalled potential in a community minded location

Price: SOLD

Council Rates: \$3,185.00/year (approx)



George Theocharis **George Theocharis**

0415 578 809
george.t@lovere.com.au

0415 578 809
george.t@lovere.com.au

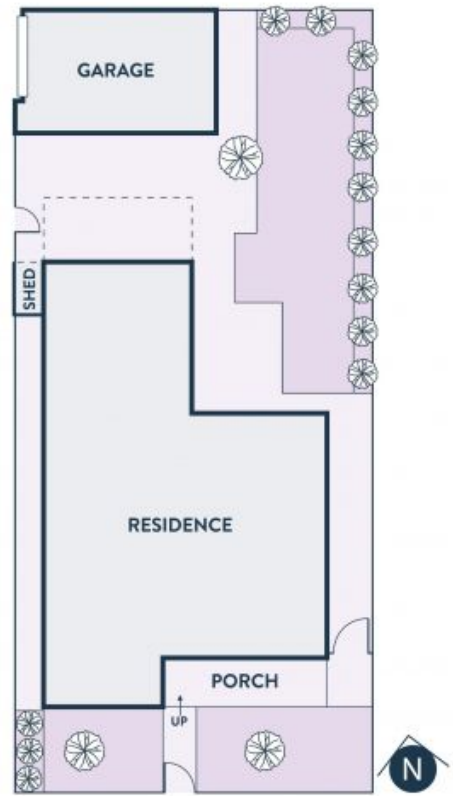

Every precaution has been taken to establish accuracy of the information in this brochure but does not constitute any representation by the vendor or agent.

48 Caroline Street

Clifton Hill, VIC

LOVE & CO