



5 Diplomat Drive Thomastown, VIC

3

2

2

### An Original Beauty

Explore a world of opportunities with this tightly-held single-level home, filled with the kind of charm only an original interior can provide whilst flaunting immense potential to the homebuyer with vision.

Awash with natural light and immaculately presented with vintage décor, the home certainly makes for a smart addition to your investment portfolio or exciting first step on the property ladder.

Standing on a generous 635sqm (approx.) block within walking distance of Carrington Children's Activity Centre, HR Uren Reserve, Thomastown Meadows Primary School and bus services and moments to TRAC, the Metropolitan Ring Road, Thomastown train station, Whittlesea Public Gardens, Epping Plaza Shopping Centre and the Northern Hospital, it's also an ideal blank canvas for those eager to make their mark with a contemporary touch.

**Price:** Sold \$700,000

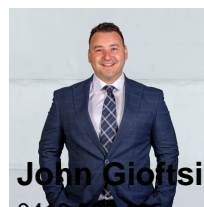

**John Giotsidis**

0416 522 195  
john.g@lovere.com.au



**Jim Vasiliou**

0418 123 634  
jim.v@lovere.com.au

### Floor Plan

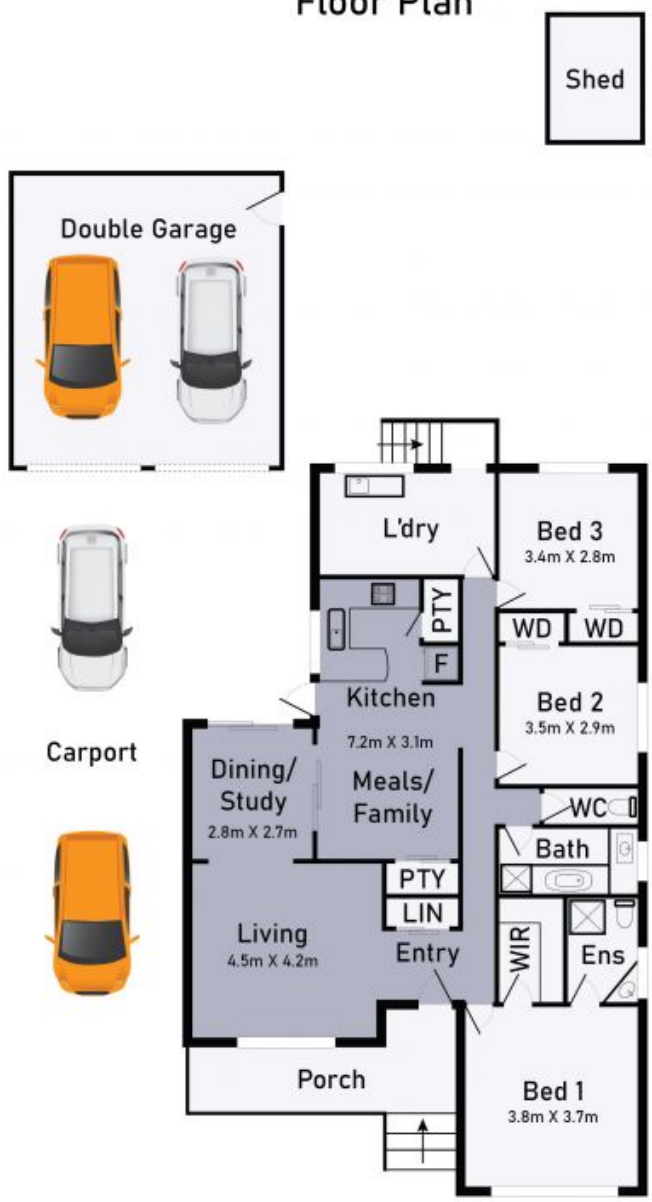

### Site Plan

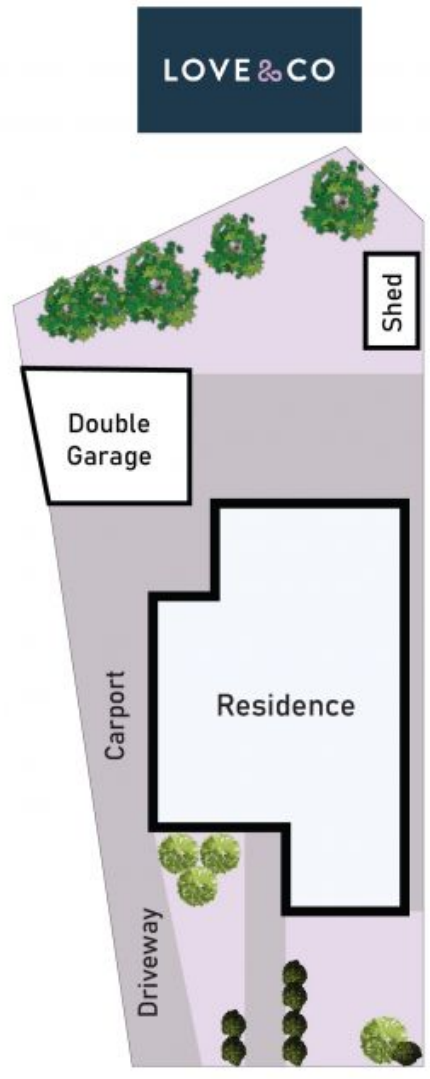

## 5 Diplomat Dr Thomastown

\* Dimensions are approximate and for illustrative purposes only



5 Diplomat Drive

Thomastown, VIC