



29 Manning Clark Road Mill Park, VIC



Smart And Spacious With A Carefree Lifestyle

If carefree living sits at the top of your checklist for the perfect property, then this quality-built three-bedroom residence located within moments of popular lifestyle assets will register a perfect match amongst savvy investors, young couples with an eye on the future, first-time buyers keen to enter the market in style and empty nesters looking to downsize - not downgrade!

Nestled in a peaceful pocket on the footsteps of Mill Park Recreation Reserve and its scenic walking tracks, bask in a world of convenience with Westfield Plenty Valley, bus services, South Morang train station and Mill Park All Abilities Play Space all within walking distance and well-regarded schools only moments away. And when you're home, enjoy the benefits of a smart and fresh single-level interior, which delights with its two separate living areas, pristine presentation and generous yet low-maintenance footprint.

Price: Sold \$595,000



John Gioftsidis
0410 522 195
john.g@lovere.com.au



Roger Pettinella
0418 588 419
roger.p@lovere.com.au

Floor Plan

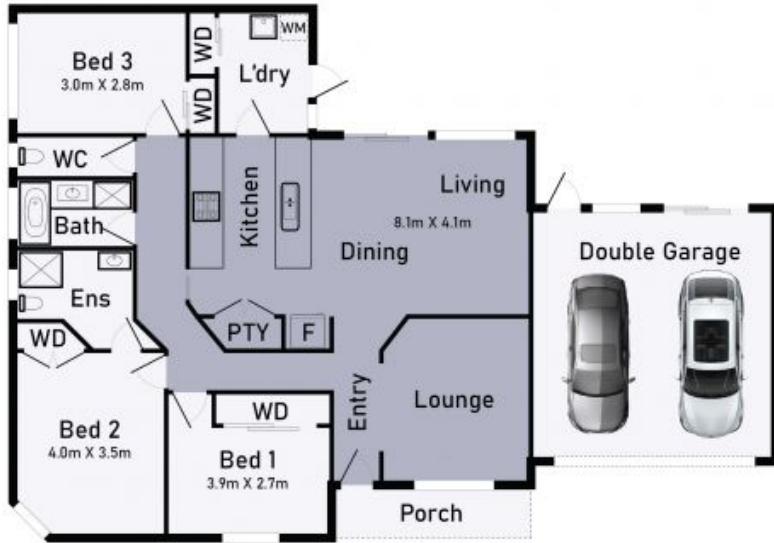

Site Plan



29 Manning Clark Road, Mill Park

* Dimensions are approximate and for illustrative purposes only

