



2 Touhey Avenue Epping, VIC



3



1



4

WALK TO THE TRAIN - BEAUTIFUL AND AFFORDABLE

A perfect start to 2023 and an exciting opportunity for first home buyers, young families and astute investors with this beautifully presented, BV family home, utilising space, natural light and great structural design whilst establishing a fantastic home in a very desirable lifestyle location.

Perfectly positioned and enjoying the tranquil surrounds of Darebin Creek recreational parklands, walking tracks, walking distance to Greenbrook Village, Epping Train Station, bus routes, an excellent choice of both primary and secondary schools including St Monica's College, just minutes to Pacific Plaza Epping Shopping/ Dining/ Entertainment Precinct, Health Services and easy access to major road arterials and freeways.

Stylishly modernised whilst retaining its classic charm, an inviting entrance welcomes you into this aesthetically appealing, spacious home where bright, neutral colours and abundance of natural light flow through effortlessly and bring in a feeling of freshness, style and a relaxed sophistication.

Price:

SOLD \$690,000

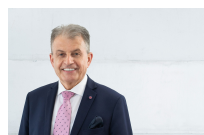

Ilia Menkinoski

0417 528 100

ilia.m@lovere.com.au



Ilia Menkinoski

0417 528 100

ilia.m@lovere.com.au

2 Touhey Avenue, Epping

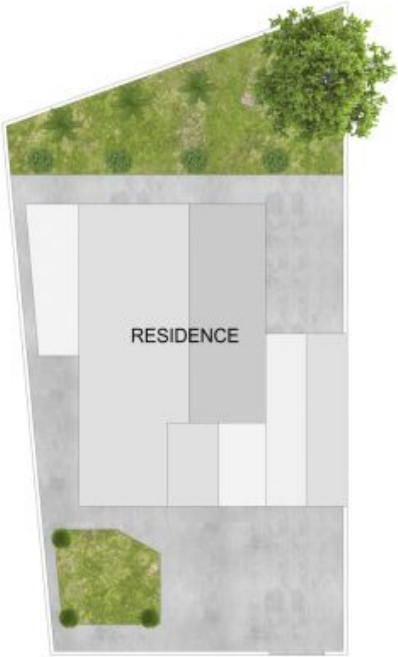

THE ABOVE PLAN IS AN ARTIST'S IMPRESSION ONLY. IT INCLUDES ELEMENTS THAT ARE FOR DISPLAY PURPOSES ONLY AND MAY NOT BE TO SCALE. LANDSCAPING SHOWN IS INDICATIVE ONLY. DIMENSIONS ARE APPROXIMATE.

LOVE & CO

2 Touhey Avenue

Epping, VIC