



12 Milyan Way Epping, VIC



3



2



2

Parkside Living At It's Finest

Signifying outstanding value in a premium pocket walking distance to Harvest Home Primary School, this three-bedroom home easily delivers on every element of modern low-maintenance living in lifestyle surrounds. The lower level offers master bedroom with built in robe and deluxe en suite followed by internal access from garage, Euro laundry while two bedrooms upstairs enjoy shared bathroom, open plan living and opening to entertainer balcony overlooking park.

- Aurora Village at the end of the street
- Striking grey stone over contemporary cabinetry
- Stainless steel appliance & dishwasher
- Carpet and tiles throughout
- Landscaped front yard
- Split system heating & cooling
- Double garage with remote

Price: \$460,000 - \$505,000



Jim Kalakias

0402 177 336

jim.k@lovere.com.au

Ground Floor

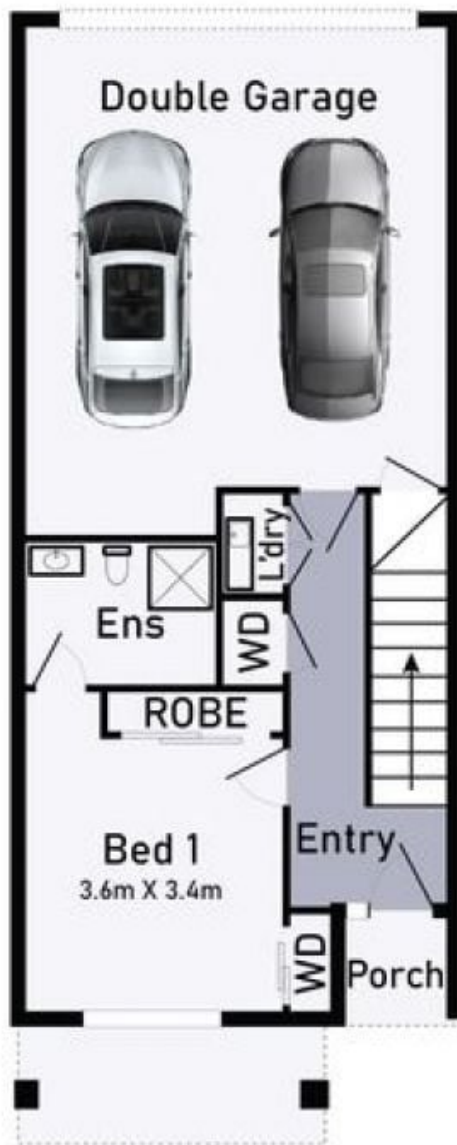

First Floor

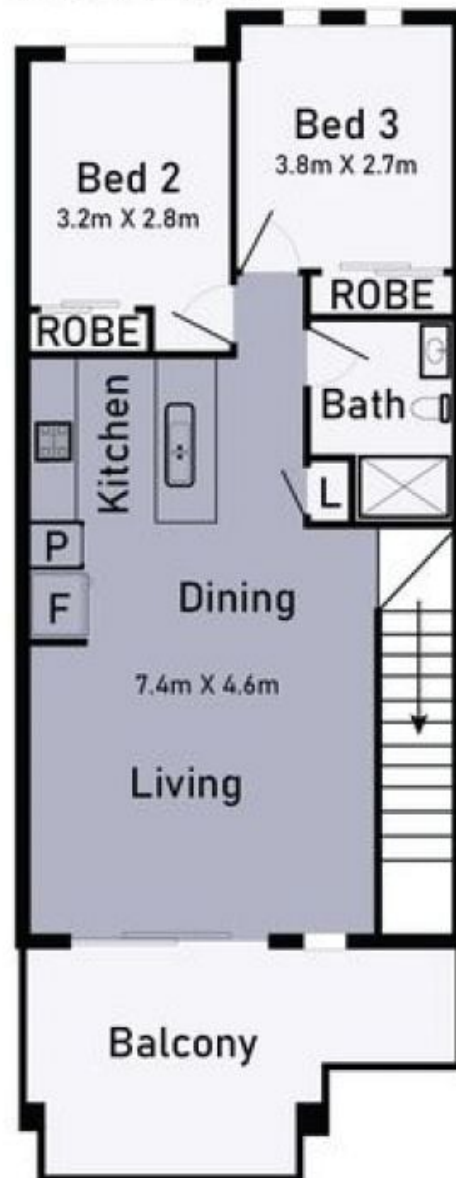

LOVE & CO

12 Milyan Way

Epping, VIC