



69 Mosaic Drive Lalor, VIC



### Light Filled, Spacious And Quality Throughout!

Private, secure and designed with ease of comfort and the highest quality in mind, this surprisingly spacious home offers stylish, sophisticated contemporary living!

Large and light-filled, the ground floor introduces the main bedroom, complete with a walk-in robe and a luxurious stone-finished ensuite. The open-plan living-dining on this level is home to a state-of-the-art kitchen introducing stone tops, sleek white cabinetry and stainless-steel appliances to create a lovely space to spoil the cook and entertain friends in style. Glass sliders open to a private courtyard that links the house to the double garage accessed via a rear lane-way. The first floor includes an open study and two bedrooms that share a deluxe stone detailed bathroom. Central to various parks, Lalor station and local shops and cafes, Epping Plaza, Costco, Epping Plaza, schools and the Northern Hospital are all within easy reach.

**Price:** \$580,000 - \$620,000



**Bijan Rahimi**

0451 515 301

loveepping@mail.inspectrealestate@lovere.com.au



**Jim Kalakias**

0402 177 336

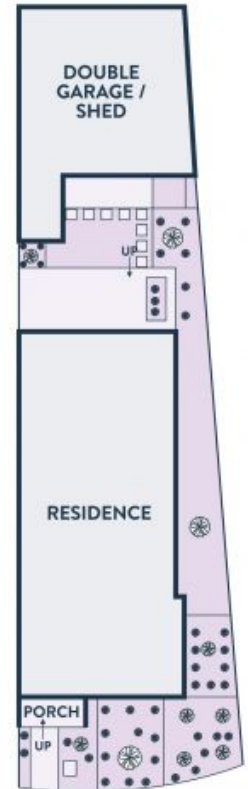
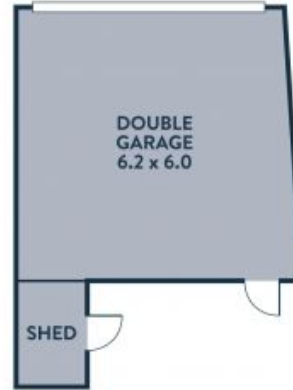
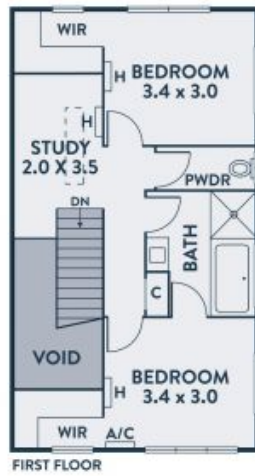
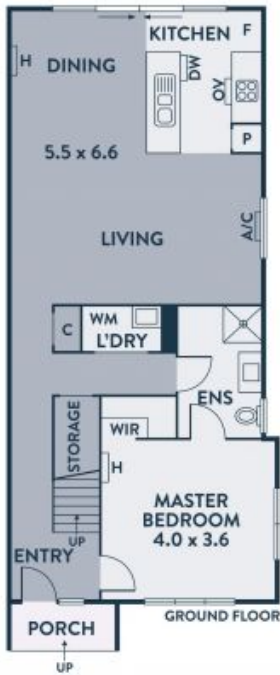

Every precaution has been taken to establish accuracy of the information in this brochure but does not constitute any representation by the vendor or agent.