



1A Trotting Place Epping, VIC



## Luxuriously Finished And Cleverly Laid Out

Styled to a demanding specification that perfectly unites detail and innovation, this as-new home introduces bold design statements within easy to live with spaces to ensure standard-setting luxury living.

The ground floor introduces a study ready to meet the demands of those looking to work from home, complementing it with a spacious open-plan living-meals. Anchored by a stunning kitchen introducing stone finishes over soft close cabinetry, a full suite of Smeg appliances including a striking black 900 mm range and a designer tiled splashback, it's a brilliant blend of form and function! Bespoke excellence continues with French doors, which extend the living out to a private courtyard finished with an emphasis on low-maintenance enjoyment.

The first floor comprises two bedrooms featuring built-in robes and their own luxurious, fully tiled ensuites, complete with stone vanities and dual-head oversize showers.



**Jim Kalakias**

0402 177 336

jim.k@lovere.com.au

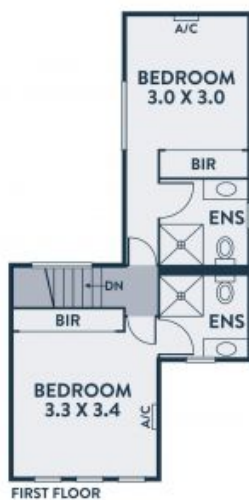

Every precaution has been taken to establish accuracy of the information in this brochure but does not constitute any representation by the vendor or agent.

**LOVE & CO**

**1A Trotting Place**

**Epping, VIC**