



1/6 Hazel Avenue Thomastown, VIC

 2
  1
  1

Spacious Single Level Villa, Fabulous Locale

Delivering contemporary living across expansive house-like proportions, this street-fronted single level unit is sure to impress. Freshly painted, the open & inviting interior has been refreshed and comprises a spacious living zone that flows freely through to the expansive kitchen and dining zone which overlooks a sun-soaked decked alfresco and incredible rear yard. Two inviting bedrooms with built-in robes, central family bathroom with large bath, shower, separate powder room & full-sized laundry complete the floorplan whilst a single garage & garden shed complete the accommodation. Positioned in an enviable pocket for fantastic lifestyle appeal, enjoy easy access to Thomastown station, M80 Ring Road as well as a host of local schools and shopping options.

Price: Sold \$470,000



John Gioftsidis
0410 522 195
john.g@lovere.com.au

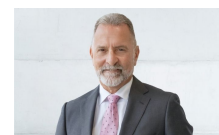

Roger Pettinella
0418 588 419
roger.p@lovere.com.au

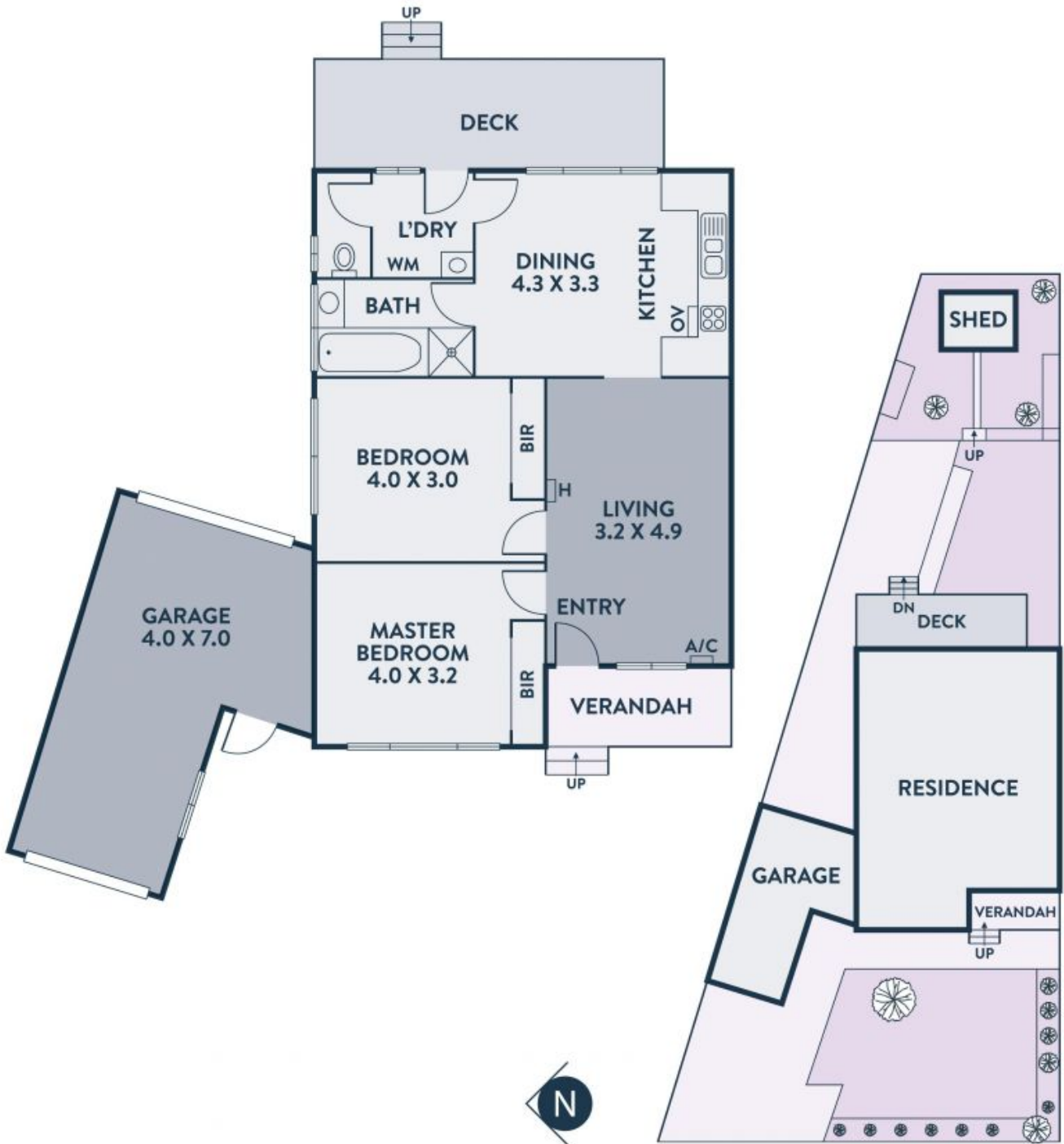

Every precaution has been taken to establish accuracy of the information in this brochure but does not constitute any representation by the vendor or agent.

LOVE & CO

1/6 Hazel Avenue

Thomastown, VIC