



2/28 Buick Crescent Mill Park, VIC

2

1

1

### The perfect start that's hard to fault ??.

This impressive free-standing unit delivers ideal single level dimensions in a thriving "Mill Park" neighborhood.

Sunfilled interior spaces include a formal lounge with elegant raked ceilings, an ultra stylish kitchen with family size bench spaces, glass splash backs and modern stainless steel appliances, all complimented by a generous meals area, 2 spacious bedrooms with BIR's, a sparkling central bathroom, split-system heating/cooling, timber-look flooring and more ?.

Add to all this, a beautiful private courtyard, a bonus and rare 'front yard', Lock-Up garage, superb gardens, immaculate presentation and a 'Blue-Ribbon" location that has Westfield Shopping Centre and South Morang station just moments away. No Strata/Owners Corp fees completes this wonderful property ?..

**Price:** Sold \$545,000

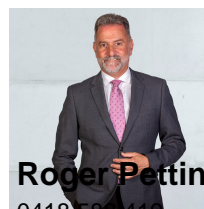

**Roger Pettinella**  
0418 588 419  
roger.p@lovere.com.au



**John Gioltsidis**  
0416 522 195  
john.g@lovere.com.au

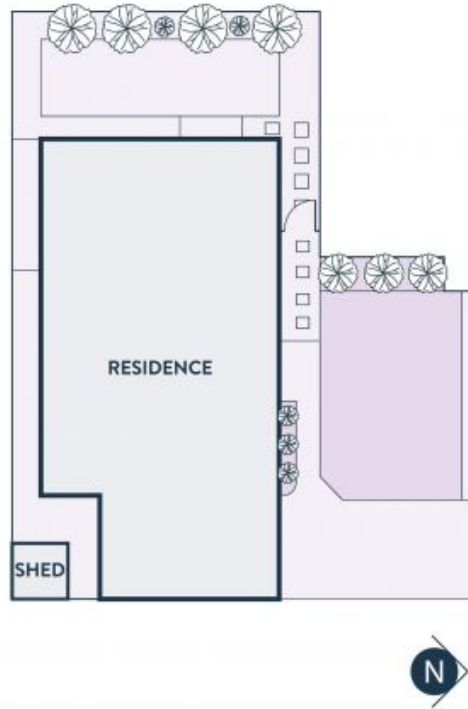

Every precaution has been taken to establish accuracy of the information in this brochure but does not constitute any representation by the vendor or agent.