



1/28 Buick Crescent Mill Park, VIC



### The perfect start in a prime location

This bright and stylishly refreshed single level home/unit located in a tightly-held and sought after Mill Park position offers the ultimate in comfort and convenience with a low maintenance lifestyle to match. Presenting a fabulous entry into the market for owner-occupiers, downsizers looking for single level ease or a great portfolio asset for savvy investors. You'll be instantly impressed by the practical design and generous proportions of this well presented abode, whilst the easy access to Westfield Shopping Centre and South Morang Station are sure to impress.

Highlights include:

- ? Street-frontage with no Strata/Owners Corp fees
- ? Large kitchen with new stainless steel appliances
- ? Full-sized laundry

**Price:** Sold \$526,000



**John Gioftsidis**

0410 522 195  
john.g@lovere.com.au

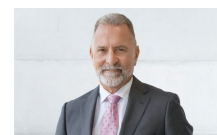

**Roger Pettinella**

0418 588 419  
roger.p@lovere.com.au

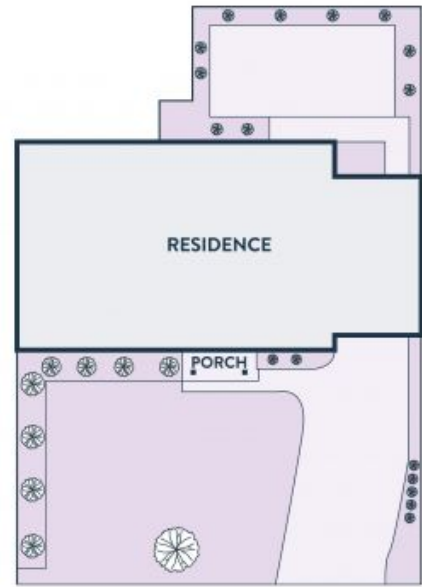

Every precaution has been taken to establish accuracy of the information in this brochure but does not constitute any representation by the vendor or agent.

1/28 Buick Crescent

Mill Park, VIC

**LOVE & CO**