



1/25 Wilmoth Street Thornbury, VIC



Sleek Contemporary Entertainer

Open for inspections at an advertised time, can take place with density limits. All attendees must be fully vaccinated, must check-in using the Service Victoria app and will be requested to provide proof of vaccination at check-in.

Defined by its luxe designer finishes, spacious open plan and vivacious sought-out location, this sleek two bedroom, two bathroom townhouse makes for a smart choice. One of three and benefitting from exclusive street frontage, the interior exhibits sundrenched scopes tailored with engineered hardwood flooring. The stone-bench kitchen stars premium s/s appliances, while entertaining is prioritised with the versatile meals/family leading to the private decked courtyard. Enviably positioned just steps to Darebin Parkland, CBD transport, Fairfield Village and High Street dining/shopping.

Price:

Contact Agent



George Theocharis Paul Spirli

0415 578 809

0430 404 673

george.t@lovere.com.au

paul@lovere.com.au



SHED
3.0 x 1.3

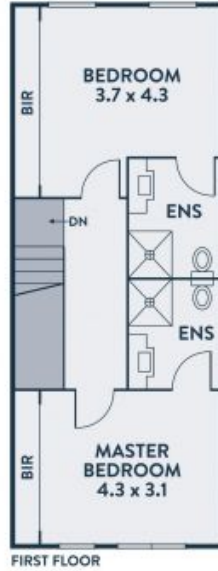

Every precaution has been taken to establish accuracy of the information in this brochure but does not constitute any representation by the vendor or agent.

LOVE & CO

1/25 Wilmoth Street

Thornbury, VIC