



201/88 Epping Road Epping, VIC

 2
  2
  1

### SPACE & STYLE

Enjoy a fabulous low maintenance lifestyle with this top floor apartment within the sought-after Waratah Gardens Estate, guaranteed to impress with its spacious design, great views and proximity to Lyndarum Village, transport and schools.

- ? Engineered timber floors
- ? Laundry facilities
- ? Main bedroom with ensuite and balcony access
- ? Split system heating & cooling
- ? Under cover parking

\*INSPECTIONS MAY BE CANCELLED UP TO 24 HOURS PRIOR WITHOUT NOTICE. YOU MUST REGISTER TO VIEW THIS PROPERTY AT AN OPEN FOR INSPECTION AND TO BE NOTIFIED OF ANY CHANGES OR CANCELLATIONS\*

**Price:** \$450 Per Week



**Rachael Kopp**



**Rachael Kopp**

lovemillpark@mail.inspectrealest lovemillpark@mail.inspectrealest

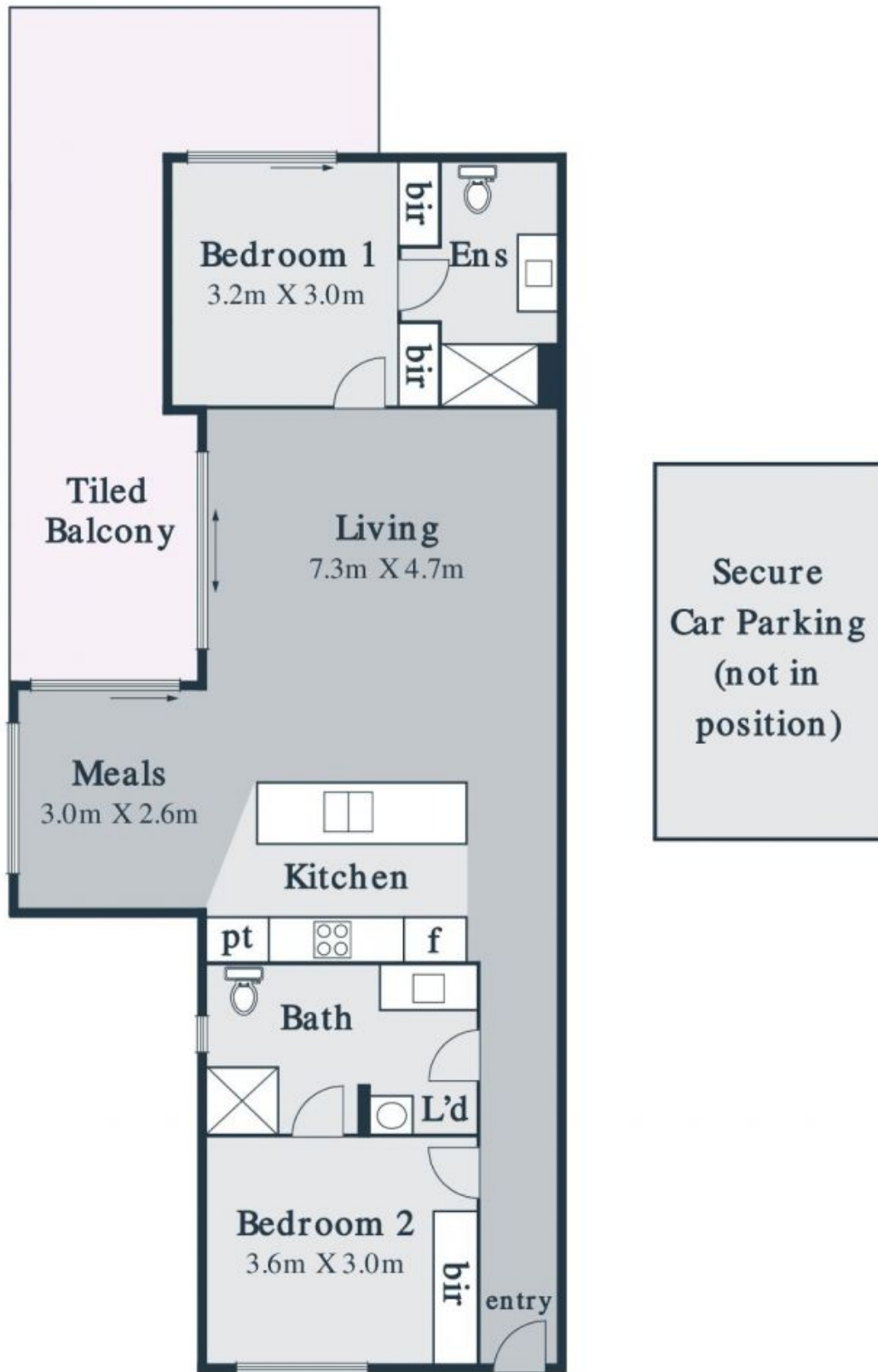

**LOVE & CO**

201/88 Epping Road Epping, VIC  
 Every precaution has been taken to establish accuracy of the information in this brochure but does not constitute any representation by the vendor or agent