



3/18 Temple Drive Thomastown, VIC

AFFORDABLE FACTORY IN PRIME LOCATION

- Factory of 140SQM (approx.)
- Roller door access
- 3 phase power
- Zoned Industrial 1

Council Rates: \$0.00 p/q
Water Rates: \$0.00 p/q
Strata Rates: \$0.00 p/q

Positioned off Settlement Road with easy access to High Street, Dalton Road and the Western Ring Road.

Rental:
 \$18,000 pa \$1,500 pcm \$346.15 pw
 (Plus outgoings and GST)



Michael Sabelberg
 0450 554 317
 michael.s@lovere.com.au



Branko Agatanovic
 0448 035 565
 branko.a@lovere.com.au

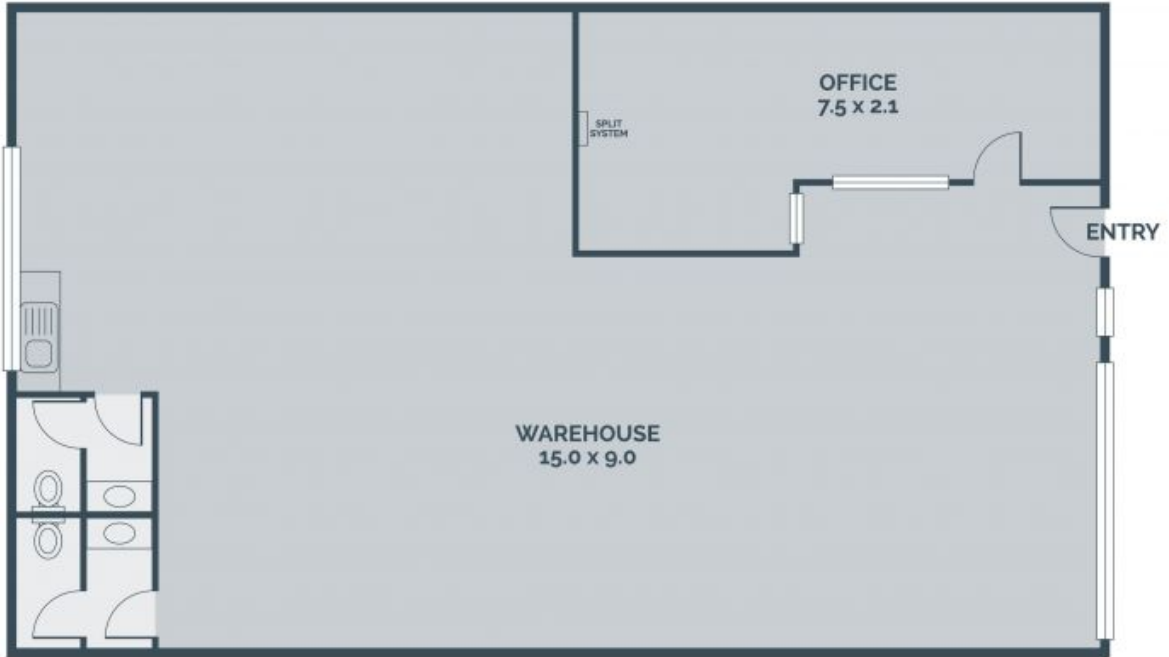

Every precaution has been taken to establish accuracy of the information in this brochure but does not constitute any representation by the vendor or agent.

LOVE & CO

LOVE & CO

3/18 Temple Drive

Thomastown, VIC