



9/146 Northbourne Road Campbellfield, VIC

EXCELLANT PROXIMITY TO HUME HIGHWAY AND COOPER STREET

- Air conditioned office of 55 SQM (approx.)
- Warehouse area of 150 SQM (approx.)
- Container height roller door
- Three phase power
- Located minutes from Hume Highway and Cooper Street
- 3 designated carpark
- Available now

Rental: \$23,000 pa, \$1,916.66 pcm, \$442.30 pw (Plus Outgoings & GST)



Michael Sabelberg

0450 554 317
michael.s@lovere.com.au



Branko Agatanovic

0448 035 565
branko.a@lovere.com.au

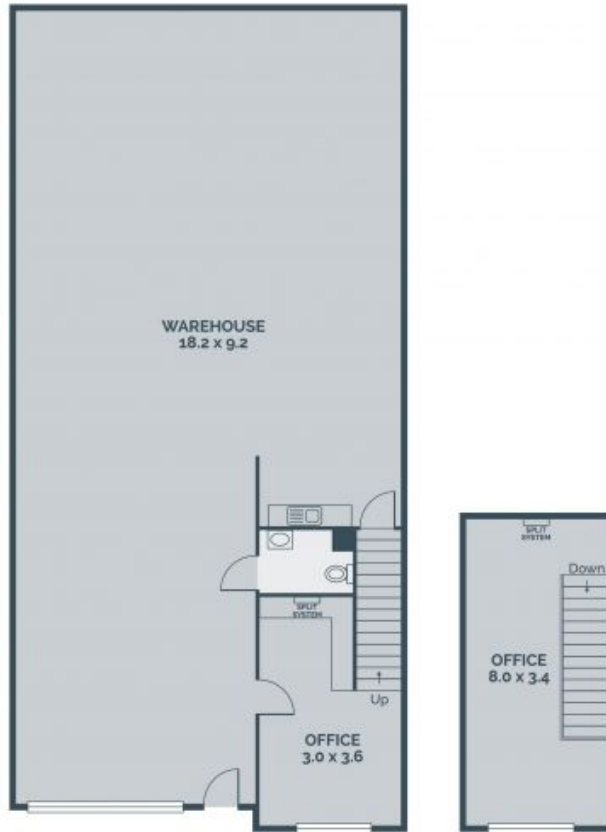

Every precaution has been taken to establish accuracy of the information in this brochure but does not constitute any representation by the vendor or agent.

LOVE & CO

9/146 Northbourne Road

Campbellfield, VIC

LOVE & CO