



4/134-136 Freight Drive Somerton, VIC

## Occupy Or Invest

Located in a tightly held Industrial One zoned location. This property offers the perfect opportunity to occupy or achieve an affordable investment:

- \* Factory/warehouse of 470m2
- \* Modern offices of 50m2
- \* High clearance electric roller door
- \* 3 phase power
- \* Male/Female toilets
- \* On-site parking
- \* Easy access to the Hume Highway and Cooper Street

Due diligence checklist - for home and residential property buyers  
<http://www.consumer.vic.gov.au/duediligencechecklist>

**Price:** \$610,000



**Michael Sabelberg**

0450 554 317  
 michael.s@lovere.com.au



**Branko Agatanovic**

0448 035 565  
 branko.a@lovere.com.au

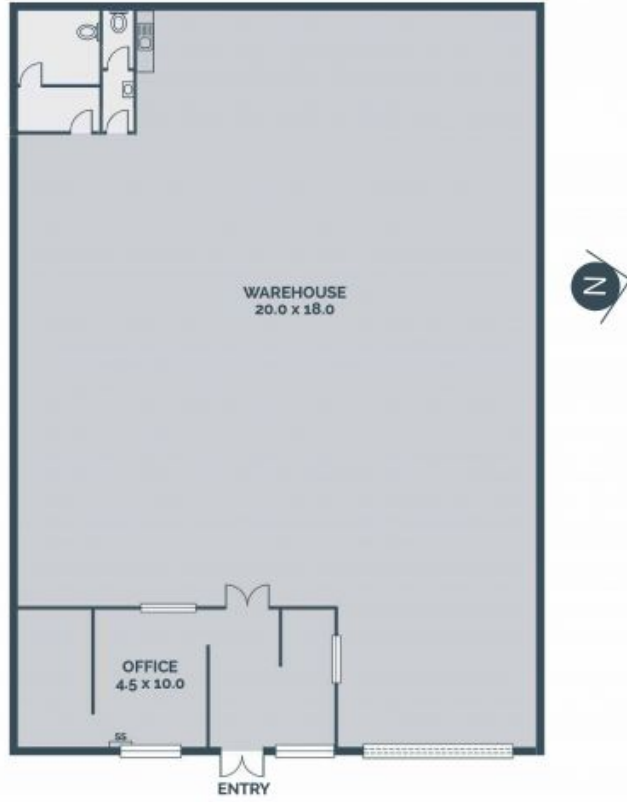

Every precaution has been taken to establish accuracy of the information in this brochure but does not constitute any representation by the vendor or agent.