



43 Fabio Court Campbellfield, VIC

PERFECT OFFICE/WAREHOUSE FOR AN EXPANDING BUSINESS

Situated within one of the north's most established industrial suburbs, 43 Fabio Crescent, Campbellfield is perfect for any business looking to expand. This modern corporate office warehouse is ideally positioned 20 kilometers (approx.) north of the Melbourne CBD and is situated minutes from the Hume Hwy and Melbourne's main arterials.

Key features include:

- 400SQM (approx.) of warehouse space with office
- High clearance electric roller door
- Lunch room plus additional kitchenette upstairs in office space
- Male & female toilets plus an additional shower upstairs
- 3 phase power
- Ample onsite parking
- Secured front yard



Michael Sabelberg

0450 554 317
michael.s@lovere.com.au



Branko Agatanovic

0448 035 565
branko.a@lovere.com.au

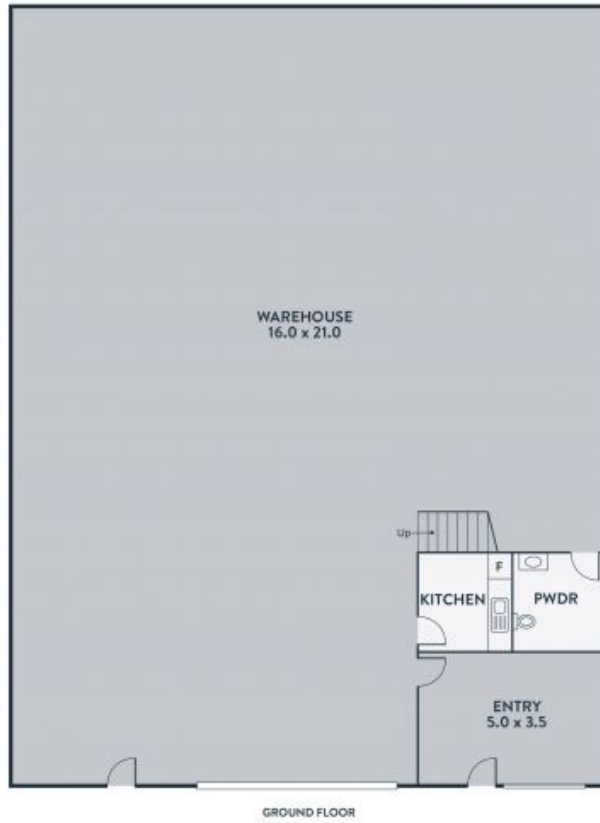

Every precaution has been taken to establish accuracy of the information in this brochure but does not constitute any representation by the vendor or agent.

LOVE & CO

LOVE & CO

43 Fabio Court

Campbellfield, VIC