



63 Prince Of Wales Avenue Mill Park, VIC



## Desirable Discovery, Delightful Location

A stylish single-level sanctuary, this perfectly presented home, surrounded by established gardens complements free flowing internal living with a variety of alfresco spaces in an ultra low-maintenance rear yard, to deliver living and entertaining options that you can enjoy from day one! The spacious interior offers lounge with woodfire heater, spacious light filled casual living, overlooked by a solid timber kitchen showcasing quality appliances and opening to an enormous covered alfresco. With living spaces balanced by four bedrooms including main with ensuite and walk-in robe, it enjoys a looked-for location close to schools, shops, parks, Westfield and the station!

- Ducted heating
- Split system heating/cooling in main living area.
- Woodfire heating to lounge
- Undercover parking secure behind roller door

**Price:** \$450 per week



**Michael Love**

0400 106 577

lovemillpark@mail.inspectrealest

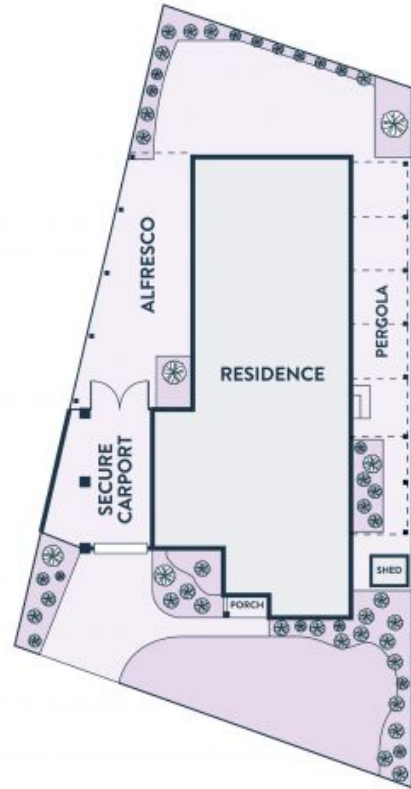

Every precaution has been taken to establish accuracy of the information in this brochure but does not constitute any representation by the vendor or agent.

