



36 Potter Street Craigieburn, VIC

**PRIME LOCATION WITH EASY ACCESS TO SYDNEY RD & HUME HWY**

If your business needs space, then this is the site for you.

Prime location with easy access to Sydney Rd & Hume Hwy.

- Multi-use factory/warehouse
- Total building area 656m2 (approx)
- Total land area 1262m2 (approx)
- Large roller door
- Toilet facilities
- Lockable gate

Suitable for a proven quality mechanic or panel beater.



**Michael Sabelberg**  
0450 554 317  
michael.s@lovere.com.au



**Branko Agatanovic**  
0448 035 565  
branko.a@lovere.com.au

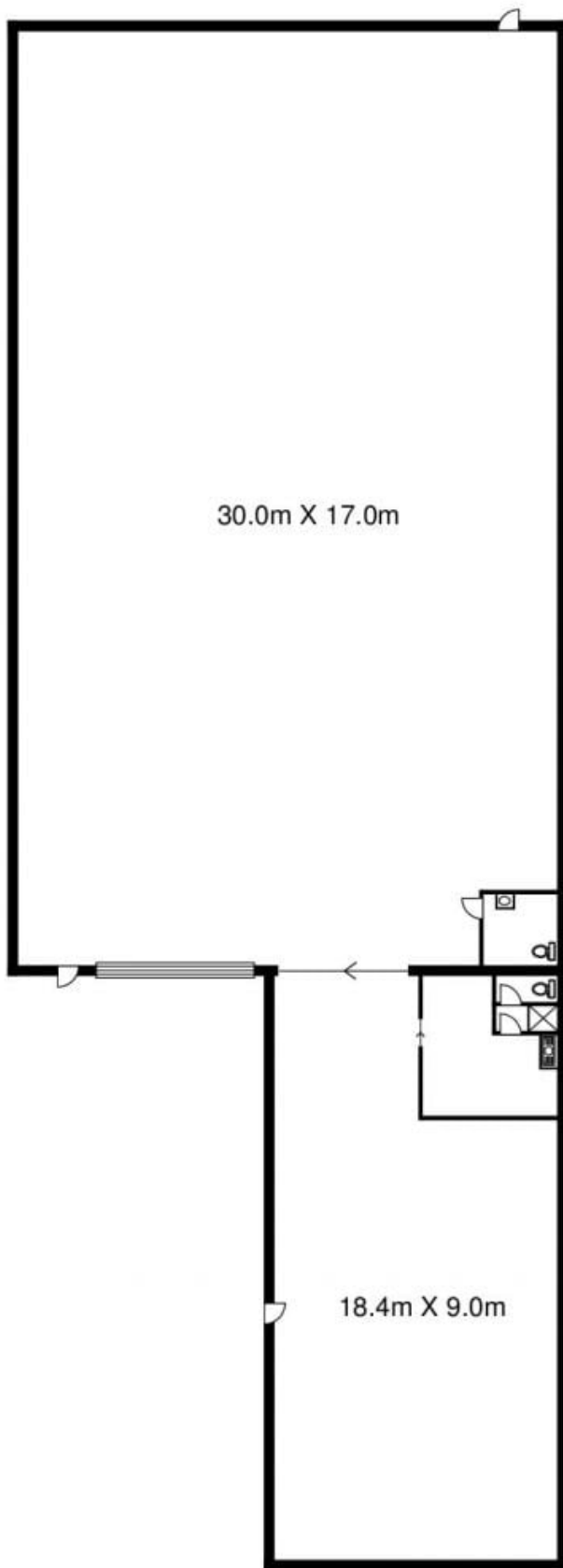

## Site Plan

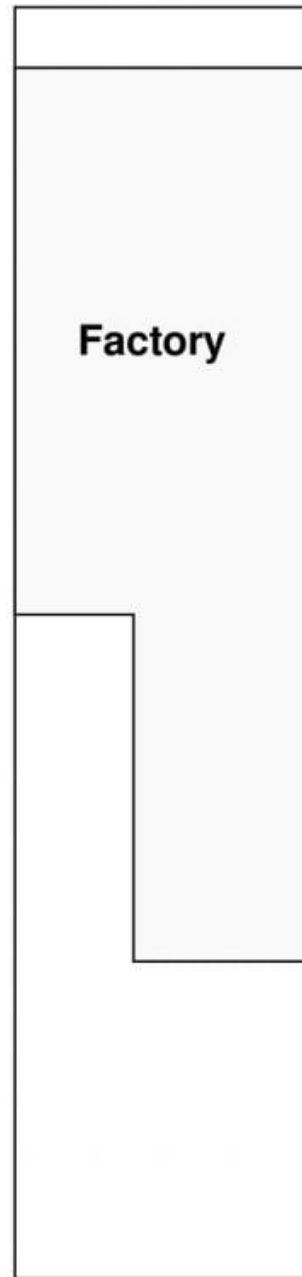

**LOVE & CO**

The information contained herein has been obtained through sources deemed to be reliable but cannot be guaranteed as to its accuracy. Any information of special interest should be obtained through independent verification.

**36 Potter Street**

**Craigieburn, VIC**