



201/88 Epping Road Epping, VIC

 2  2  1

### Spacious & Stylish

Enjoy a fabulous low maintenance lifestyle with this top floor apartment within the sought-after Waratah Gardens Estate, guaranteed to impress with its spacious design, great views and proximity to Lyndarum Village, transport, schools and Epping Plaza. Bathed in natural light, it offers two bedrooms, (both with ensuites) complementing open plan living anchored by a stone, glass and stainless-steel kitchen and stepping out to a private entertainer's terrace.

- ? Engineered timber floors
- ? Laundry facilities
- ? Main bedroom with ensuite and balcony access
- ? Split system heating & cooling
- ? Under cover parking

**Price:** \$350 Per Week



**Toula Lovett**

lovemillpark@mail.inspectrealest

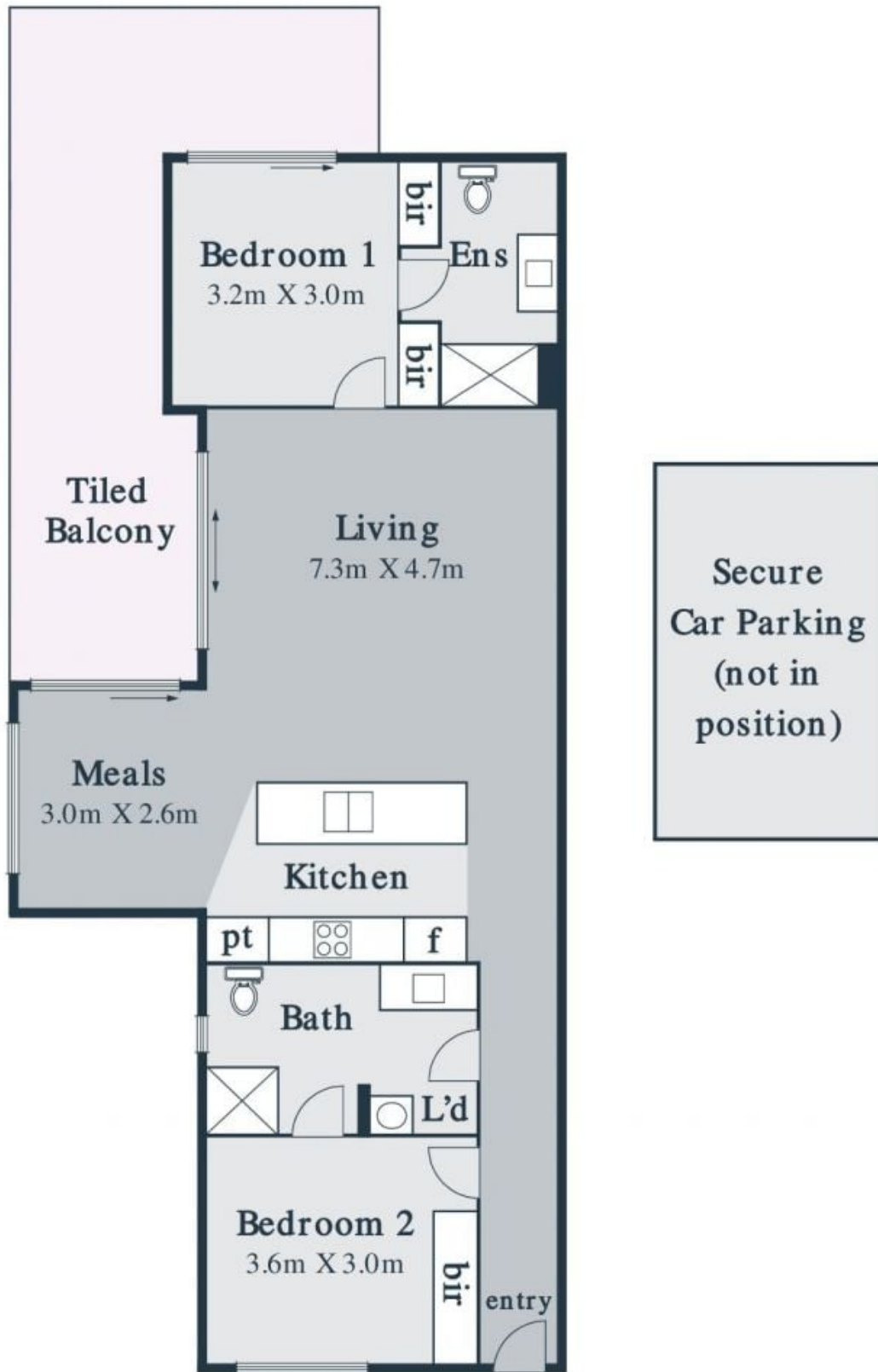

**LOVE & CO**

201/88 Epping Road Epping, VIC  
 Every precaution has been taken to establish accuracy of the information in this brochure but does not constitute any representation by the vendor or agent