



49 Great Brome Avenue Epping, VIC



**STYLISHNESS, SIZE & LOCATION, WHAT A WINNER! \*Insp Thu 9th Jan @ 4:30pm & Sat 1**

**Price:** \$525 per week

Located in Epping's sought after Lyndarum Estate and a short stroll to O'herns park, Lyndarum shops and bus route 358 which takes you directly to Pacific Epping, Epping Train Station and High Street this well presented family home will amaze.

Comprising;

- Four good size bedrooms
- Ensuite and walk in robe to master bedroom
- Open Study
- Built in robes
- Kitchen with open plan meals/living areas
- Dishwasher
- Walk in pantry to kitchen



**Alyssa Pagano**

loveepping@mail.inspectrealestat

# 49 Great Brome Ave. Epping

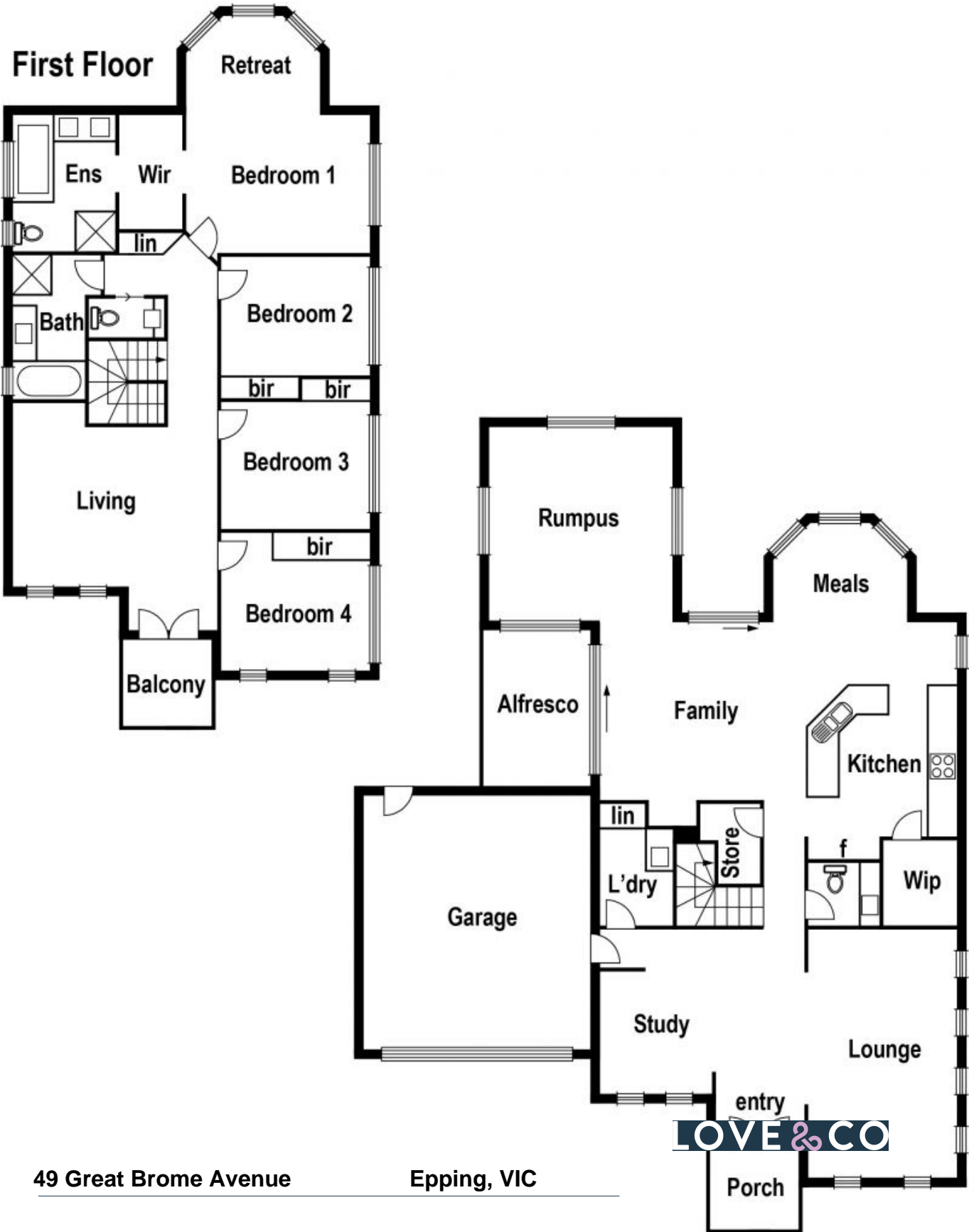

49 Great Brome Avenue

Epping, VIC