



9/1 Austarc Avenue Thomastown, VIC

## GREAT VALUE WAREHOUSE/FACTORY

- Factory/ Warehouse space of 567 SQM (approx)
- Office space of 57 SQM (approx)
- 3 phase power available
- Dual roller door access
- Ample Parking
- Zoned Industrial 1
- Easy access to Western Ring Road

\$33,500 per annum plus outgoings and GST (if applicable)

\$2,791.66 per month plus outgoings and GST (if applicable)

\$644.23 per week plus outgoings and GST (if applicable)



**Branko Agatanovic** **Michael Sabelberg**

0448 035 565

0450 554 317

branko.a@lovere.com.au

michael.s@lovere.com.au

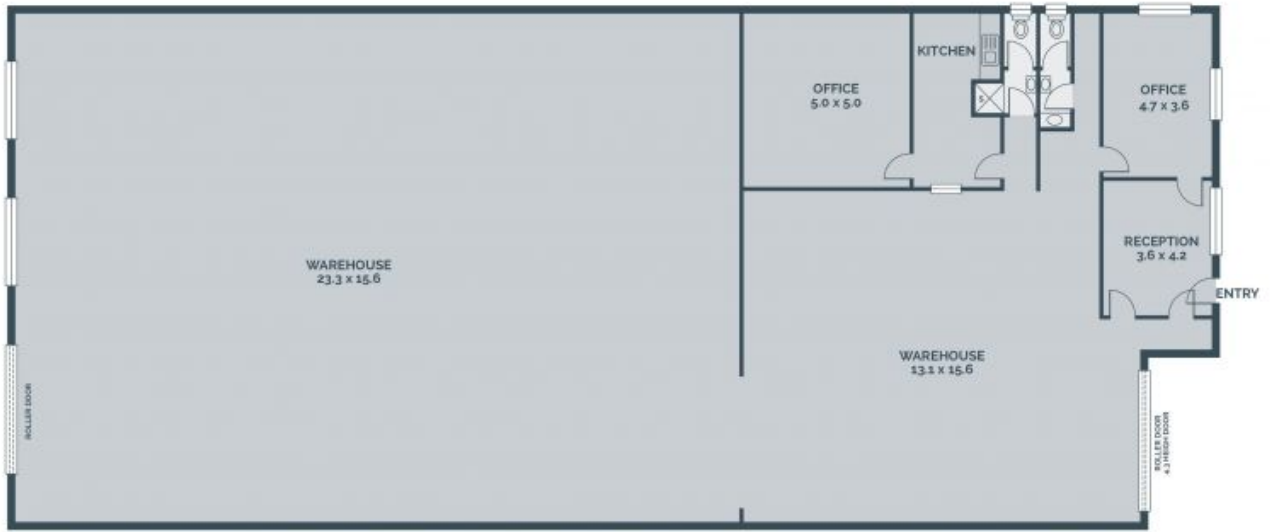

Every precaution has been taken to establish accuracy of the information in this brochure but does not constitute any representation by the vendor or agent.

**LOVE & CO**

**LOVE & CO**

**9/1 Austarc Avenue**

**Thomastown, VIC**