



50 Davisson Street Epping, VIC



4



2



1

PRIME LOCATION

This well presented home set in a central location with convenient amenities such as Epping train station, your choice of primary/secondary schools and shops only a short distance away!

Comprising:

- 4 Bedrooms
- Walk In Robe's
- Ensuite
- Built In Robes
- Gas Heating
- Gas Cooling

Other features include a spacious lounge, kitchen/ meals area, seperate family room, garage and a workshop.



John Quinonero

john.q@lovere.com.au

Price: \$360 - \$380 Per Week

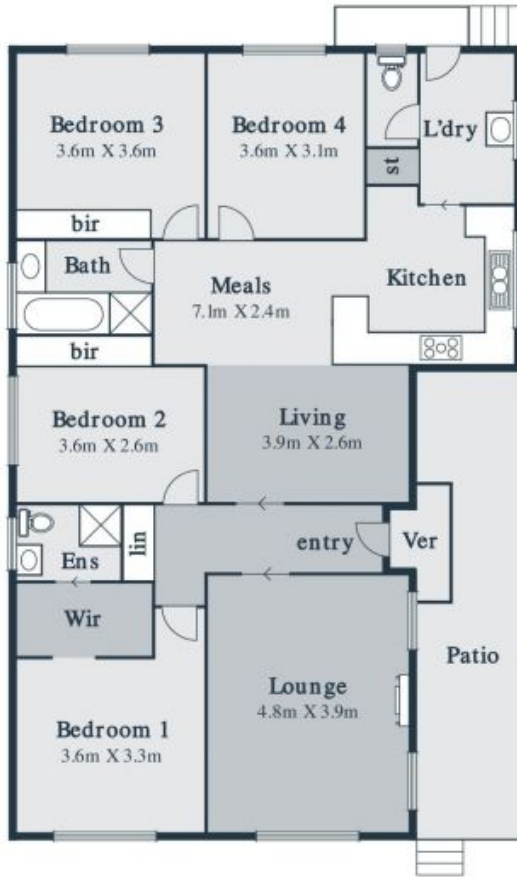

Every precaution has been taken to establish accuracy of the information in this brochure but does not constitute any representation by the vendor or agent