



3 Pearce Road Wollert, VIC



4



2



2

Quality Family Living

Set Negotiation: Tuesday 26th March at 6:00pm (Unless Sold Prior)

Price: \$540,000 - \$560,000

This four bedroom, two bathroom home provides an irresistible invitation to experience quality family living in a sought after pocket that enjoys easy access to Aurora Village, Harvest Home Primary School, Contempo park and transport. Enhanced by neutral tiles, generous formal living complements an equally expansive casual living/family zone. Integrating an entertainers kitchen with quality stainless steel appliances, it opens to a private backyard to ensure wonderful living and entertaining flexibility.

- Double garage, internal access
- Ducted heating, split system unit
- Stainless steel hot plate & oven
- Fabulous central location
- Ensuite to main



George Stathopoulos

0403 053 836

george.s@lovere.com.au

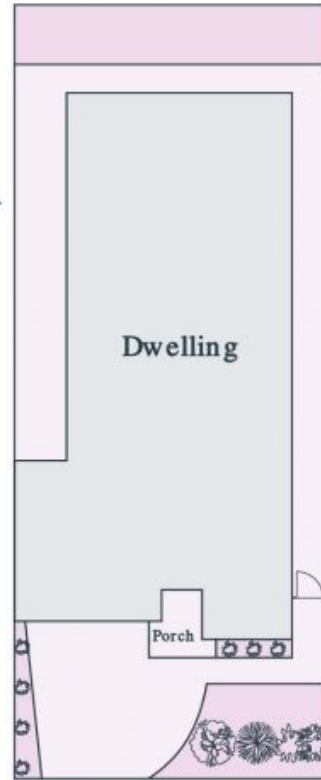

Site Plan

Every precaution has been taken to establish accuracy of the information in this brochure but does not constitute any representation by the vendor or agent

