



7/213-215 Camp Road Campbellfield, VIC

2

2

1

STYLISH TOWNHOUSE LIVING!

This spacious townhouse offering all the comforts for an enjoyable home within minutes to Sydney Road bus services, Ring Road and Broadmeadows Shopping Centre.

- Tiled downstairs area with separate lounge
- Open plan kitchen meals/family area
- Stainless steel cooking appliances
- Powder room
- Single remote controlled garage.

Upstairs are 2 double bedrooms with built in robes

- Large central bathroom with bath.
- Spacious laundry,
- Gas ducted heating
- Rear courtyard.

Price: \$330-\$350PW



Rachael Wallace

loverealestate@mail.inspectreale

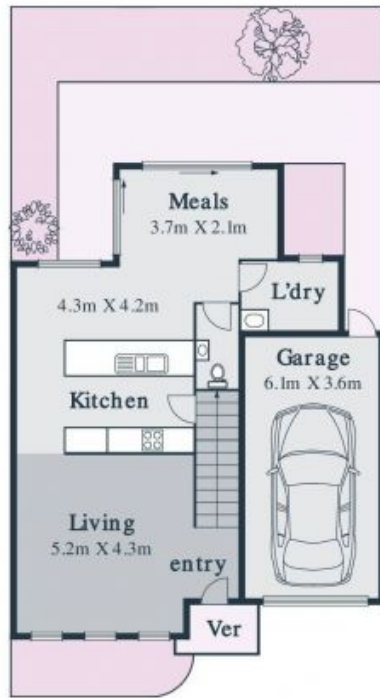

Every precaution has been taken to establish accuracy of the information in this brochure but does not constitute any representation by the vendor or agent