



4 Fitzgerald Drive South Morang, VIC



### Family Innovation. Family Friendly Location

With four bedrooms, two bathrooms, study, two living areas and generous alfresco zone, this as new family haven blends the space families need, the location they desire and the low maintenance living they dream of. Set among a cluster of parks, a short walk from the bus, Coles, cafes, kinder and P-9 school and within easy reach of a choice of train stations, Marymede and Westfield, it provides bigger than expected spaces across two light-lavished levels in a desirable easy-care setting. Act now!

- ? Ducted heating and cooling
- ? Ensuite to main, family bathroom and guest powder
- ? Double garage with laneway entry
- ? Alfresco with lawn for the kids
- ? Formal and casual living spaces
- ? Kitchen with stainless steel appliances
- ? NBN connected

**Price:** SOLD \$605,000



**Nick Kandi**  
0412 310 704  
nick.k@lovere.com.au



**John Giottsdis**  
0416 522 195  
john.g@lovere.com.au



**First Floor**

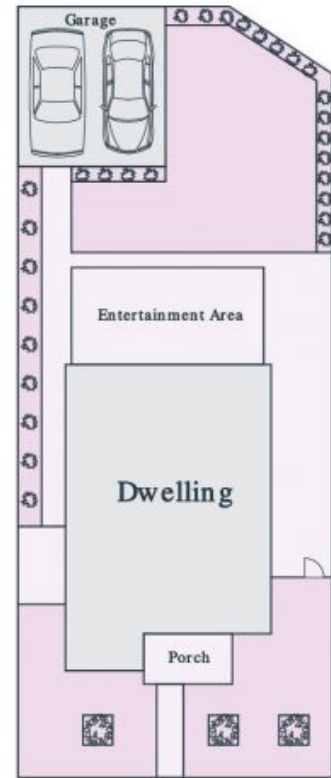
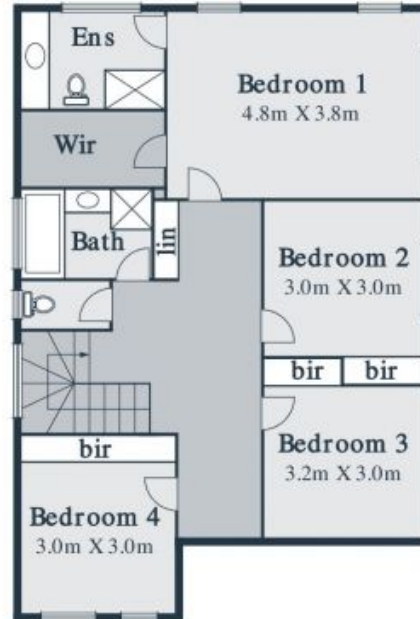

**Site Plan**

Every precaution has been taken to establish accuracy of the information in this brochure but does not constitute any representation by the vendor or agent



**4 Fitzgerald Drive**

**South Morang, VIC**