

12 Norwich Avenue Thomastown, VIC

CLEAN VERSATILE FACTORY/WAREHOUSE

- Approx 425 Sqm approx of warehouse inclusive of 20 Sqm approx of office space
- Sealed and painted concrete floor
- Close to major arterials such as the Western Ring Road, Mahoney's Road, Dalton Road etc
- 3 Phase power
- Container height roller door
- Six car spaces
- Excellent truck access

AVAILABLE 15th of JANUARY



Branko Agatanovic

0448 035 565

branko.a@lovere.com.au

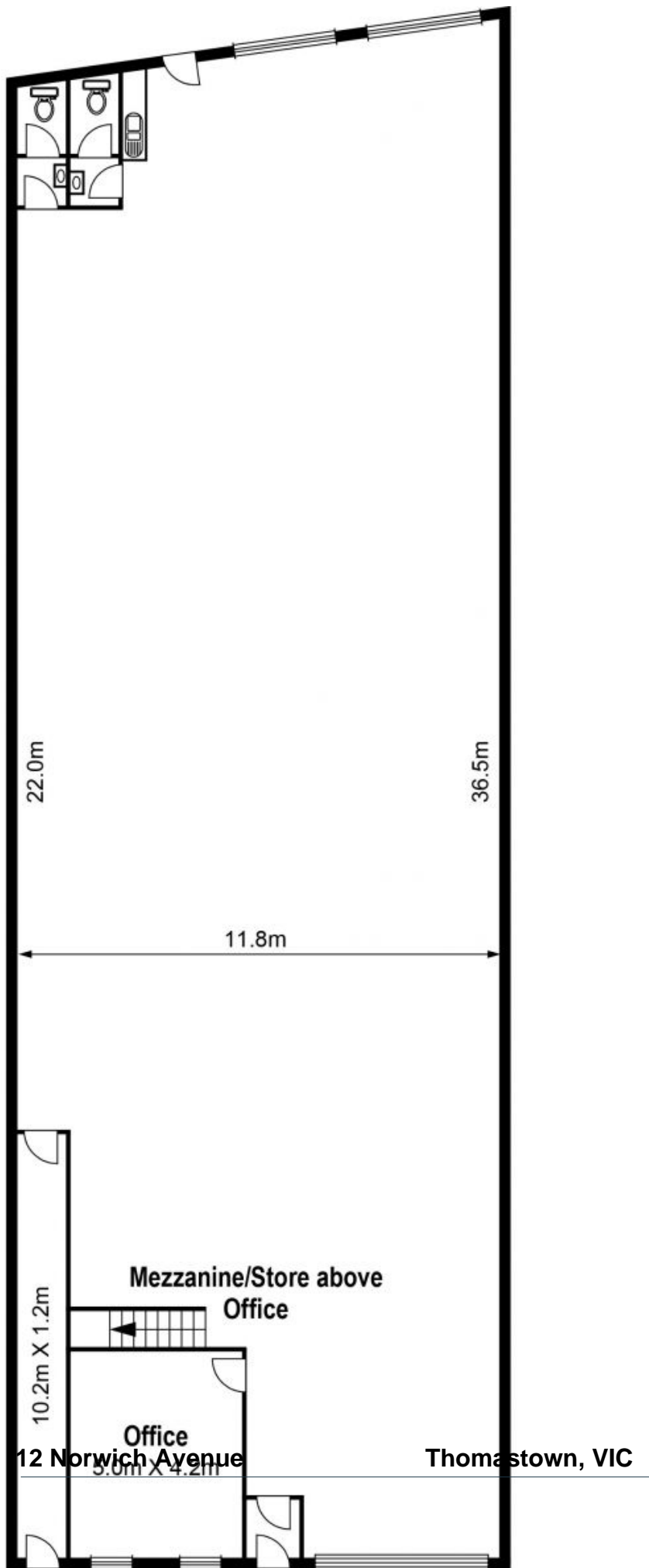

Site Plan

