



2 Asquith Court Epping, VIC

3

2

2

Spacious And Perfectly Positioned

This immaculate family friendly home offers relaxed living, within easy reach of just about every desired amenity! This spacious home offers formal living, expansive casual living and a generous rumpus room that steps out to a covered outdoor zone.

Comprising;

- Three bedrooms
- Ensuite and walk in robes to master bedroom
- Built in robe to remaining bedrooms
- Ducted heating
- Evaporative cooling
- Ducted vacuum
- Shed
- Remote Double Garage with drive through access

Price: \$385 Per Week



Michael Love

0400 106 577

lovemillpark@mail.inspectrealty



Mill Park Reception

millpark.leasing@lovere.com.au

2 Asquith Crt. Epping

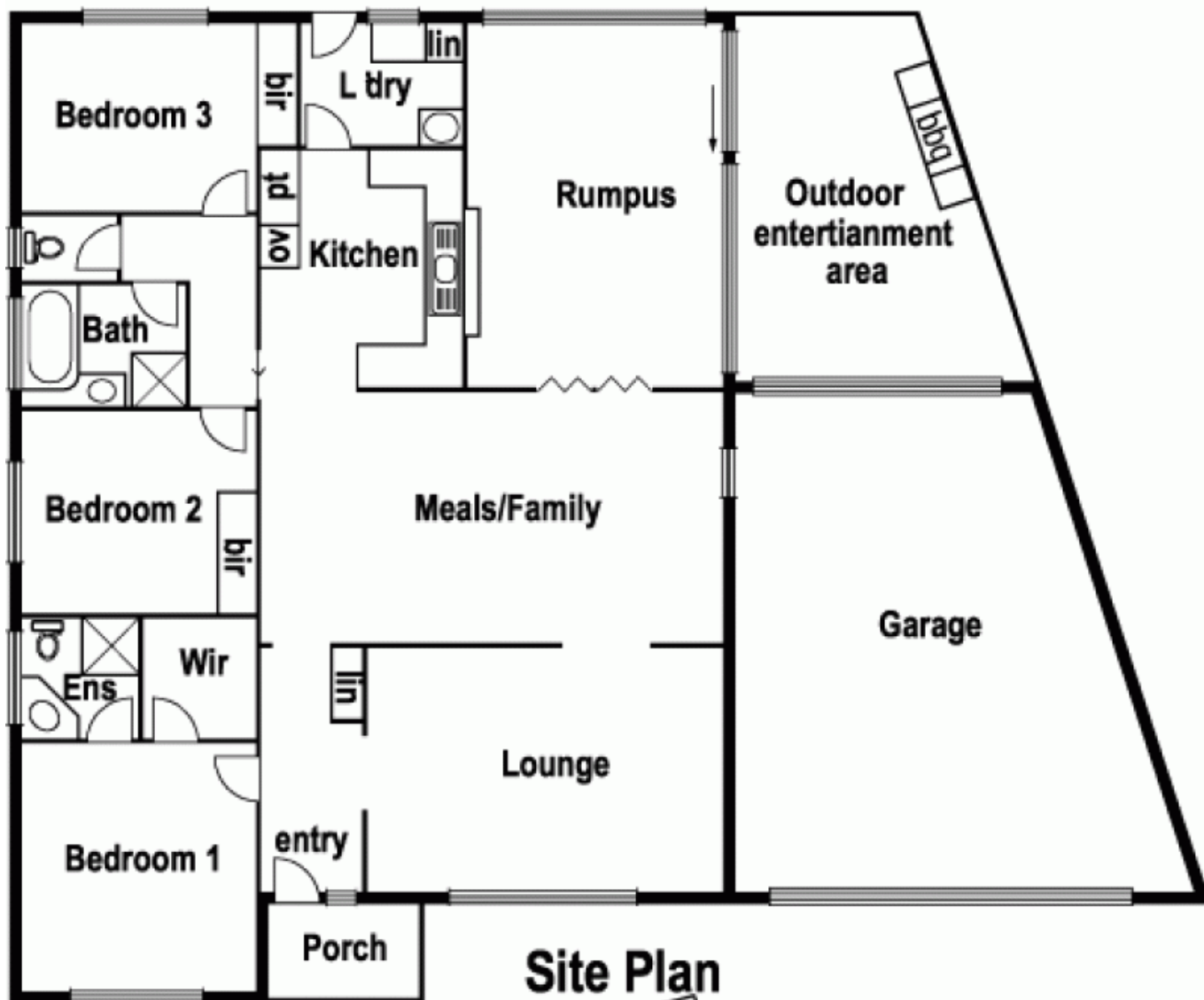

Site Plan

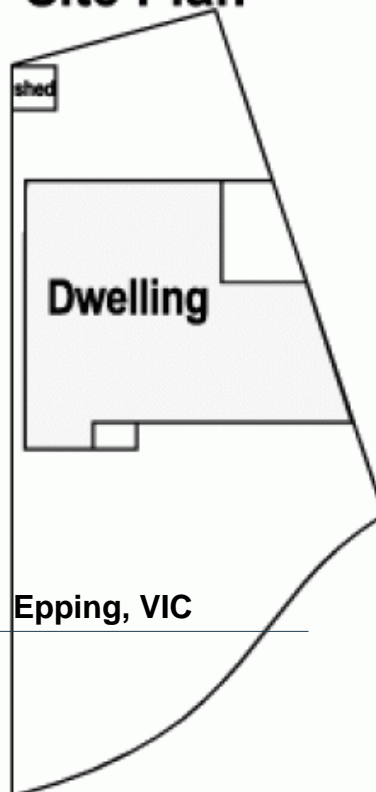

LOVE & CO

2 Asquith Court

Epping, VIC