



314-360 Childs Road Mill Park, VIC

### Retail Space in Vibrant Shopping Centre

- Located in popular Stables Shopping Centre
- Area approx 50m2
- Excellent parking
- Neighbours in this dynamic shopping centre include Woolworths Supermarket, Commonwealth Bank and a wide range of variety shops.

All offers will be presented to the vendor



**Michael Sabelberg**  
0450 554 317  
michael.s@lovere.com.au



**Branko Agatanovic**  
0448 035 565  
branko.a@lovere.com.au

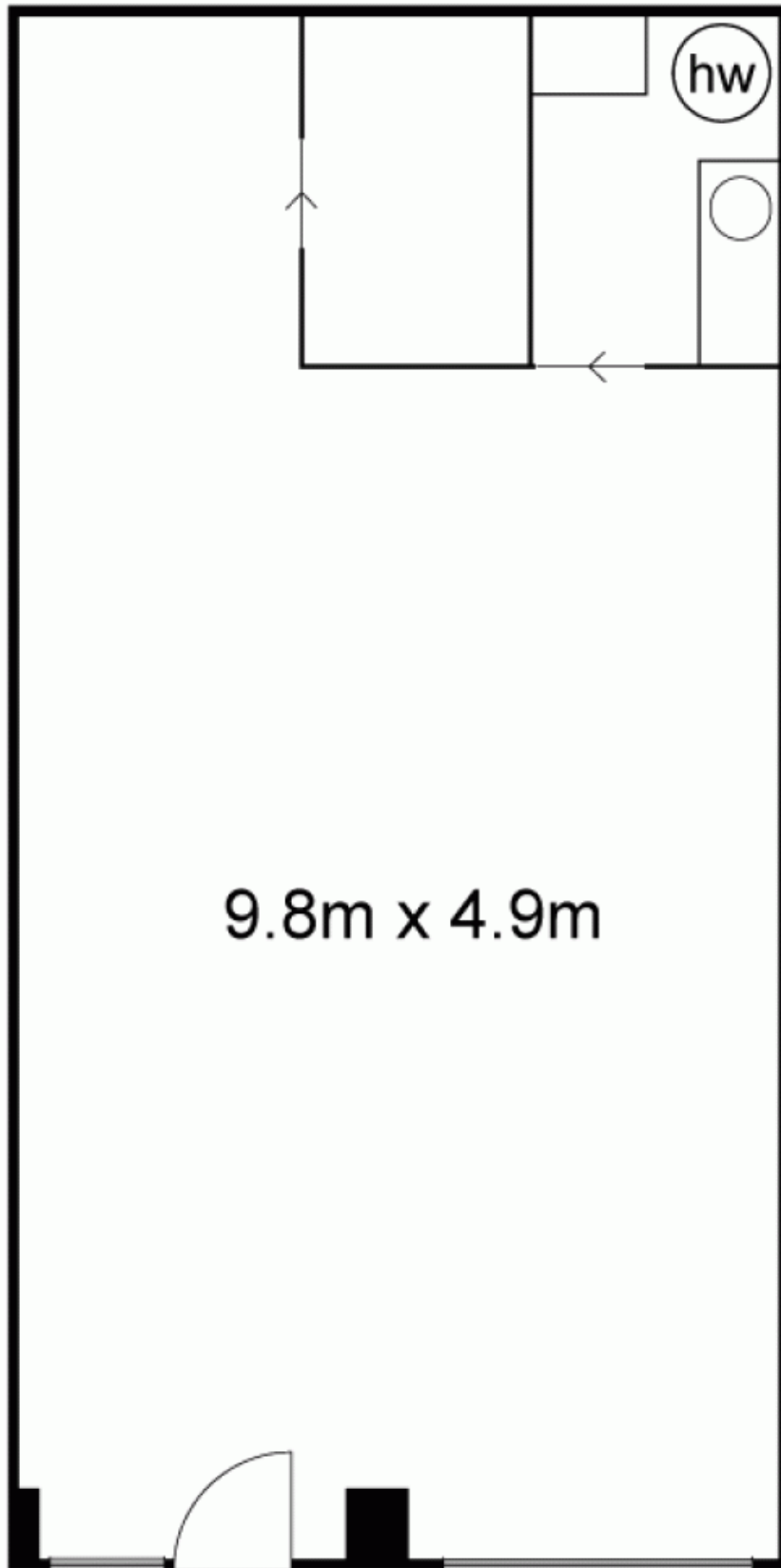

LOVE & CO

The information contained herein has been obtained through sources deemed to be reliable but cannot be guaranteed. Any information of special interest should be obtained through independent verification.

314-360 Childs Road Mill Park, VIC