



36 Potter Street Craigieburn, VIC

PRIME LOCATION WITH EASY ACCESS TO SYDNEY RD & HUME HWY

If your business needs space, then this is the site for you.

Prime location with easy access to Sydney Rd & Hume Hwy.

- Multi-use factory/warehouse
- Total building area 656m2 (approx)
- Total land area 1262m2 (approx)
- Large roller door
- Toilet facilities
- Lockable gate

Suitable for a proven quality mechanic or panel beater.

Rental \$37,600 PA - \$3133.33 PCM - \$723.07 PW



Michael Sabelberg
0450 554 317
michael.s@lovere.com.au



Branko Agatanovic
0448 035 565
branko.a@lovere.com.au

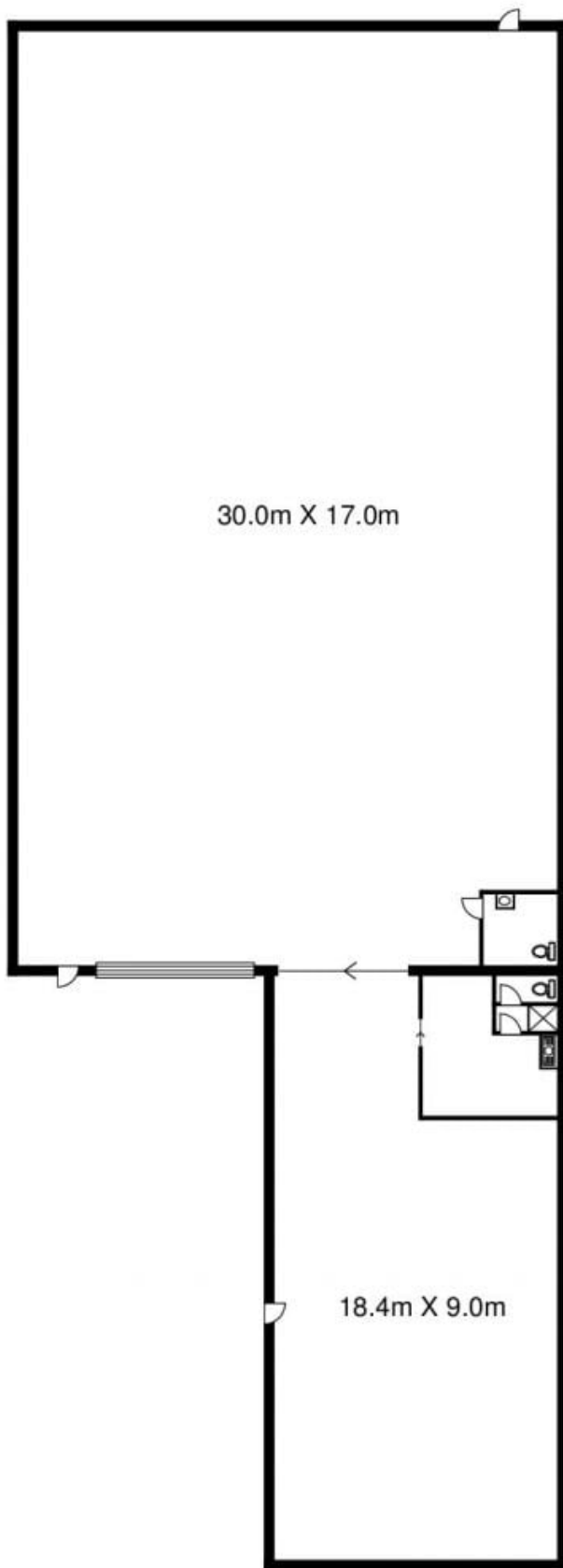

Site Plan

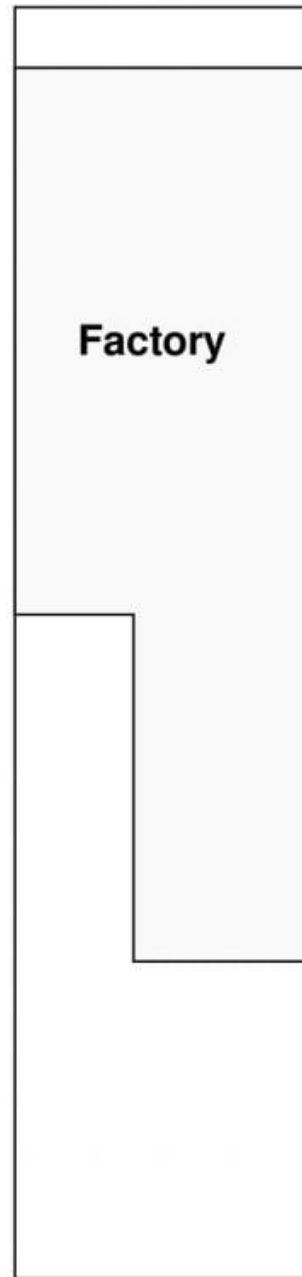

LOVE & CO

The information contained herein has been obtained through sources deemed to be reliable but cannot be guaranteed as to its accuracy. Any information of special interest should be obtained through independent verification.

36 Potter Street

Craigieburn, VIC