



7 Parer Street Reservoir, VIC

VERSATILE FACTORY IN POPULAR INDUSTRIAL AREA

Available now - Call to inspect!

- Great location - Easy access to main roads and freeways
- Secure front lockable yard with car spaces
- Land size 640 m2 (approx)
- Total building size: 465 m2 (approx)
- Office/showroom area: 37.5 m2 (approx)
- 2 x refurbished toilets
- Upgraded lighting
- Industrial 1 Zoning
- Located in popular industrial area.

\$40,000 pa, \$3,333.33pcm, \$767.12 pw, Plus GST and Outgoings if applicable.



Michael Love
0400 106 577
michael.l@lovere.com.au



Michael Sabelberg
0450 554 317
michael.s@lovere.com.au

7 Parer Street. Reservoir

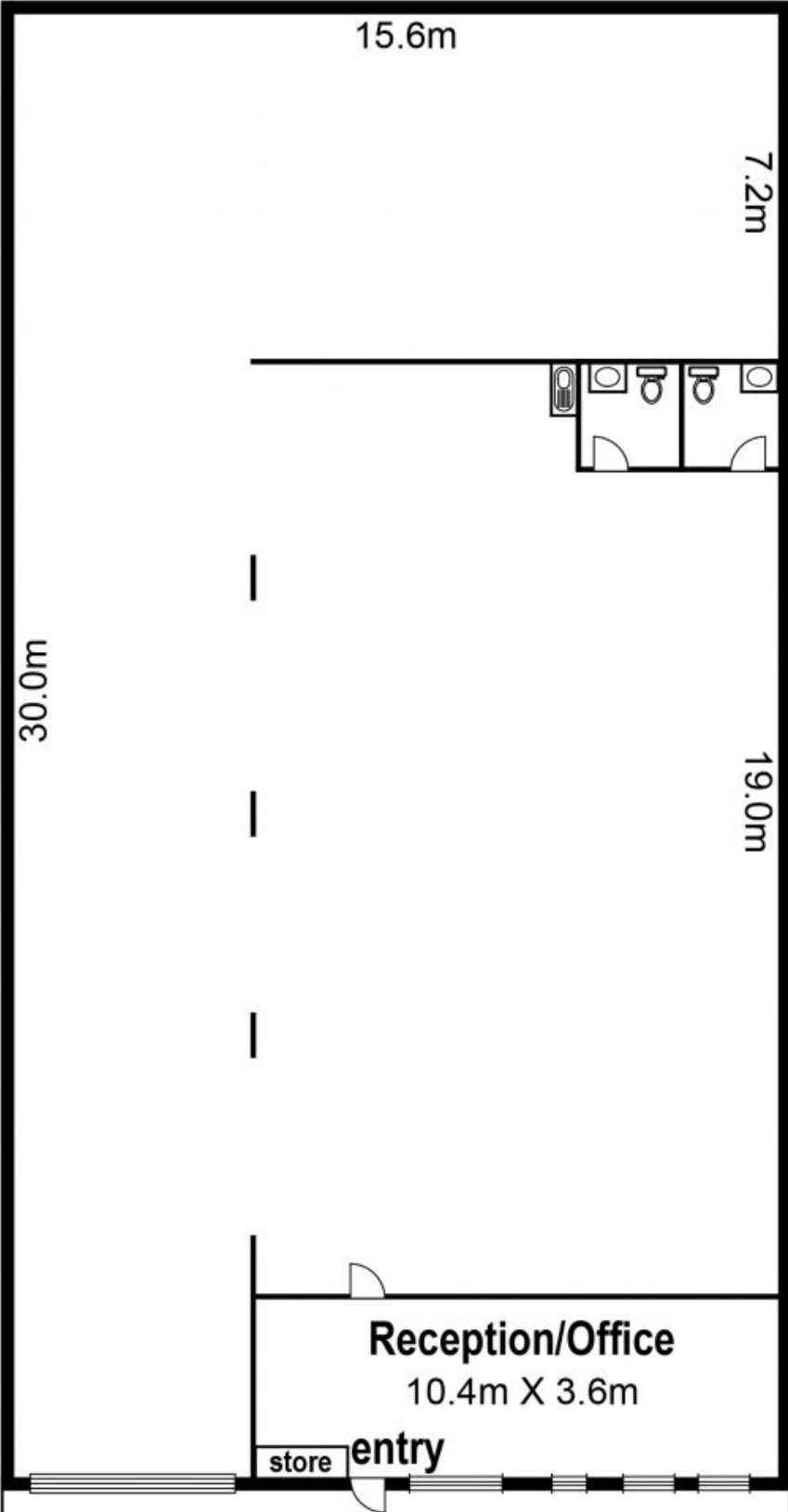

LOVE & CO

7 Parer Street

Reservoir, VIC

Car Parking