



14 Malua Crescent Mill Park, VIC



Dream Opportunity. Desired Location

An expansive rear yard featuring a generous all-weather alfresco with woodfire heater and a huge gym/retreat/games room perfectly complements this immaculate renovated home. Engineered timber floors, quality carpet, unmarked neutral paintwork, ducted heating and split system units all enhance an interior featuring formal lounge-dining and an equally spacious family living-meals. Overlooked by a contemporary kitchen with quality stainless steel appliances, plenty of bench space and an abundance of storage options, it enjoys seamless access through sliding doors to the alfresco, ensuring relaxed year-round entertaining. The main bedroom includes his and hers robes and a modern ensuite with floor to ceiling tiles and designer touches, a theme repeated in the family bathroom. A short walk to primary and secondary schools, bus, The Stables, Uni Hill, RMIT and the tram for an easy trip to the city, it's a dream opportunity in a desired location.

Price: SOLD - \$726,000



Nick Kandi
0412 310 704
nick.k@lovere.com.au



Nick Kandi
0412 310 704
nick.k@lovere.com.au

14 Malua Crescent, Mill Park

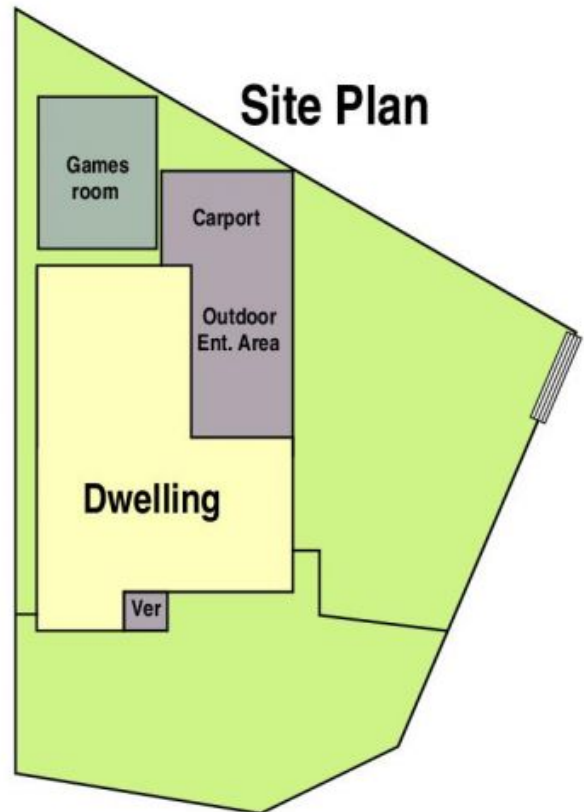
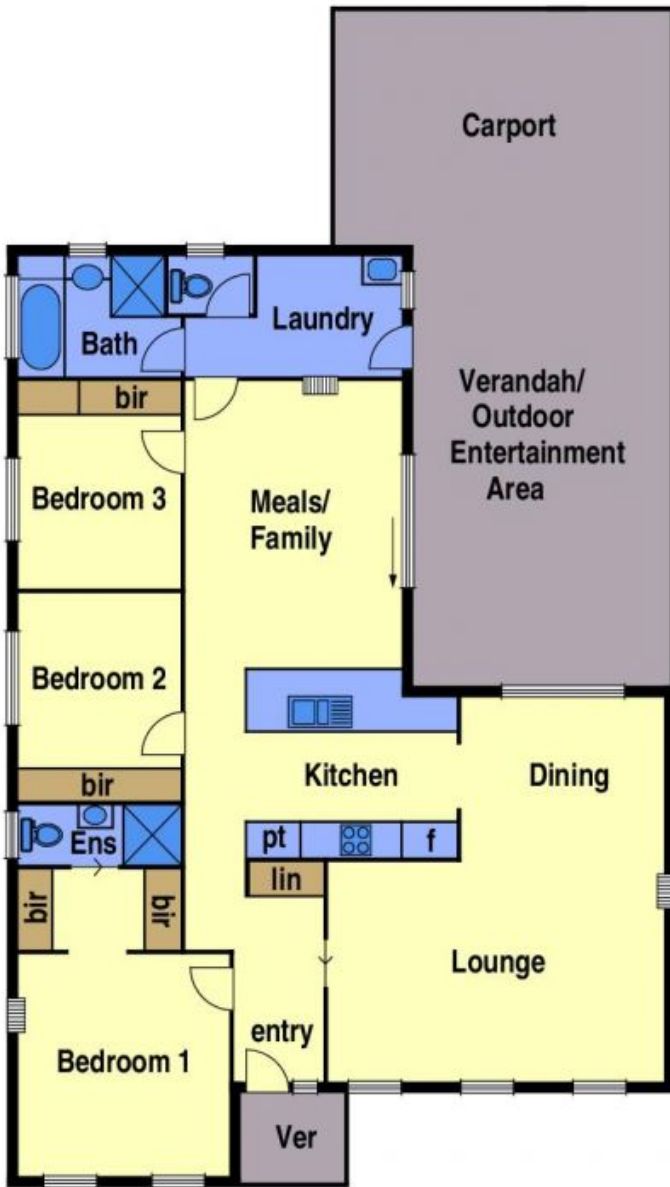

The information contained herein has been obtained through sources deemed to be reliable but cannot be guaranteed as to its accuracy. Any information of special interest should be obtained through independent verification.

14 Malua Crescent

Mill Park, VIC