



1/12 Buckmaster Drive Mill Park, VIC



3



2



1

Make Your Entry Into An In Demand Location

Don't settle for life in a big group or living with no land, this perfectly presented single level home, one of only two, sits at the front of the block behind a deep front lawn which is complemented by a courtyard and generous private rear yard. An entry terrace, large enough to put out the chairs and enjoy the sun, opens to an interior introducing new carpet throughout the formal living room, family living/meals over looked by the kitchen and three bedrooms, including main with ensuite and walk in robe. Moments to the bus, Redleap Reserve, The Stables shopping centre with its, shops, caf?'s and takeaways, primary and secondary schools and with easy access to Uni hill, RMIT and the tram, you can get ahead of the pack in a perfect position.

Price: 425000



Nick Kandi

0412 310 704

nick.k@lovere.com.au

1/12 Buckmaster Dv. Mill Park

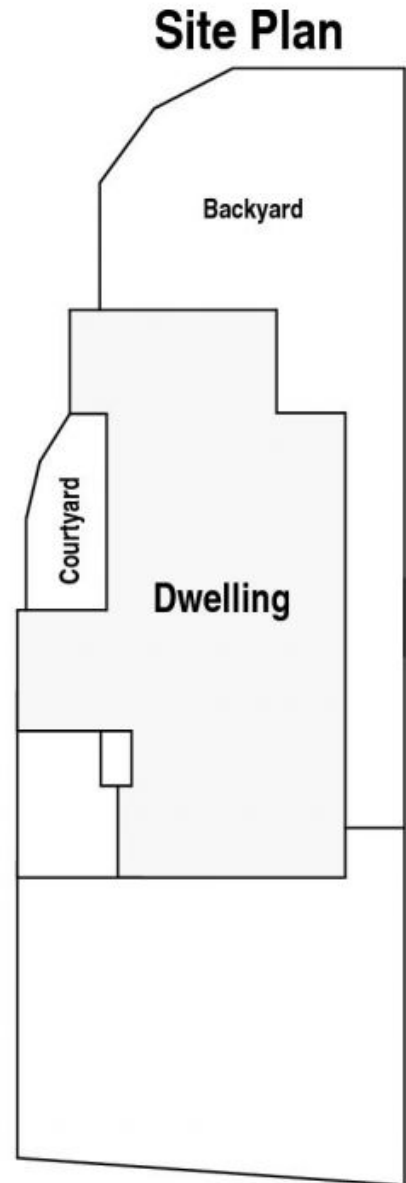

The information contained herein has been obtained through sources deemed to be reliable but cannot be guaranteed as to its accuracy. Any information of special interest should be obtained through independent verification.

1/12 Buckmaster Drive Mill Park, VIC