



11 Mahon Road EPPING, VIC



2



1

PICK OF THE BUNCH - TURN KEY PACKAGE WITH STREET FRONTAGE

Price: SOLD \$250,000

Nearing completion, this two bedroom unit presents as an alluring option for investors, first home buyers and downsizers. Offering a convenient and compact lifestyle, the floor plan offers two spacious bedrooms, centrally poised bathroom and fully equipped kitchen with adjoining meals and lounge zone. Also including a car space on title, the supreme unit is within short proximity to Epping North shopping precinct and transport.

Features include:

- Stainless steel appliances
- Stone benches
- Reverse cycle heating/cooling
- Downlights
- Spacious courtyard
- Landscaped gardens (including letterbox and clothes line)
- Garden shed

Estimated Completion Date: September, 2013.

With First Home Owners Grant and stamp duty savings applicable, plans and full list of inclusions list are available on request.

LOVE & CO

Love Epping

epping@lovere.com.au

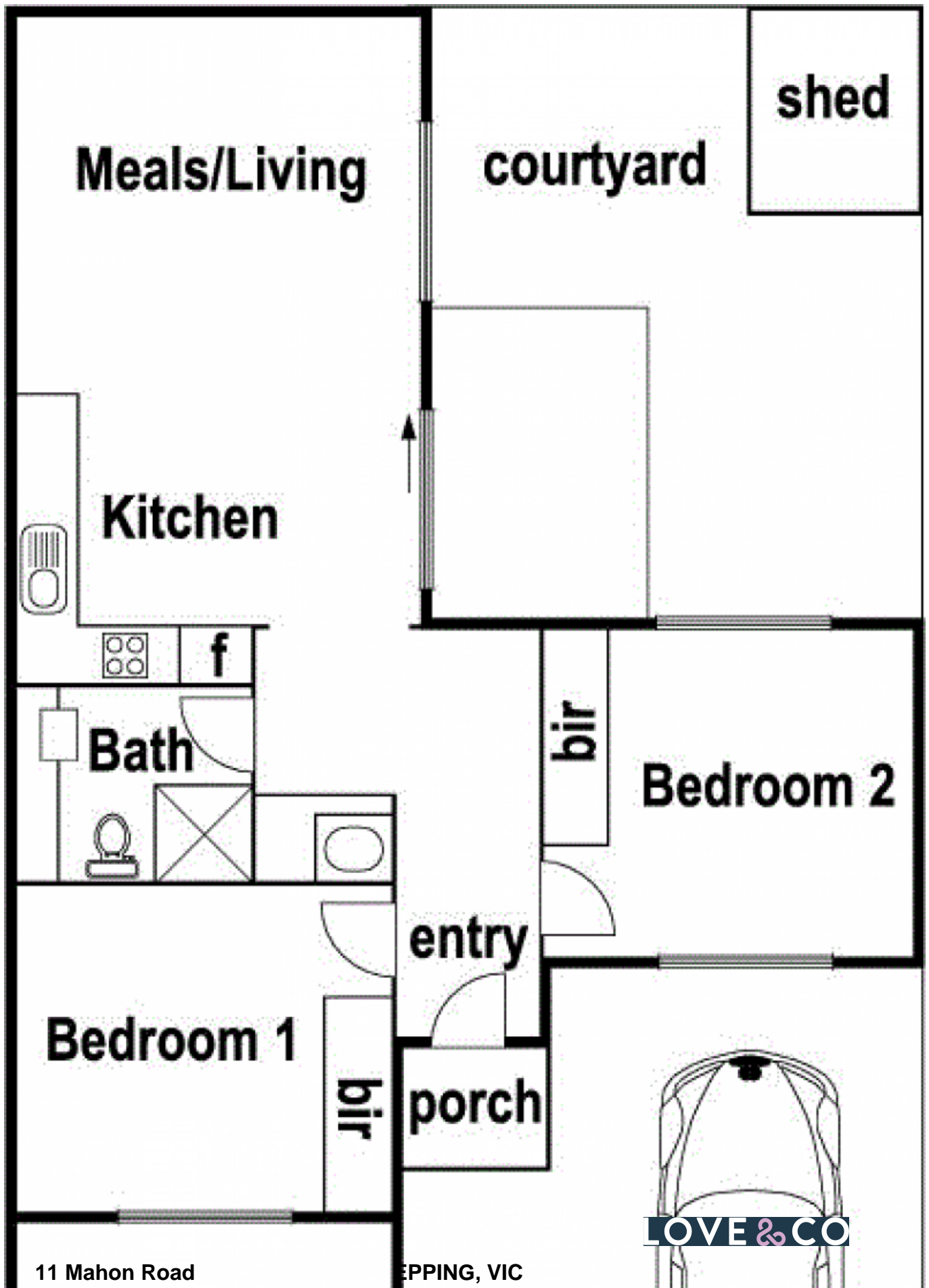

LOVE & CO