



1376 Plenty Road Bundoora, VIC



Prime Development Site

The house sits on a very impressive allotment of 607m2 approx. currently consists of 4 generous sized bedrooms plus study/5th bedroom. Master bedroom with walk in robe and en-suite. Central main bathroom, huge kitchen meals/dining area that leads to a spacious lounge/family room. Externally you have a large low-maintenance rear yard as well as ample car parking at the front. Located in the heart of Bundoora close to transport, shops, parks and schools. Preliminary plan and permit for 5 x two bedroom townhouses available, please contact me for a copy.

- Outstanding Location in Central Bundoora
- Preliminary plan and permit for 5 x two bedroom townhouses
- 607m2 approx with 15.86m Frontage approx
- Currently leased at \$1,608 pcm
- Route 86 Tram and bus just at the front



Ken Gu
0433 428 060
ken.g@lovere.com.au



Ken Gu
0433 428 060
ken.g@lovere.com.au

1376 PLENTY RD BUNDOORA

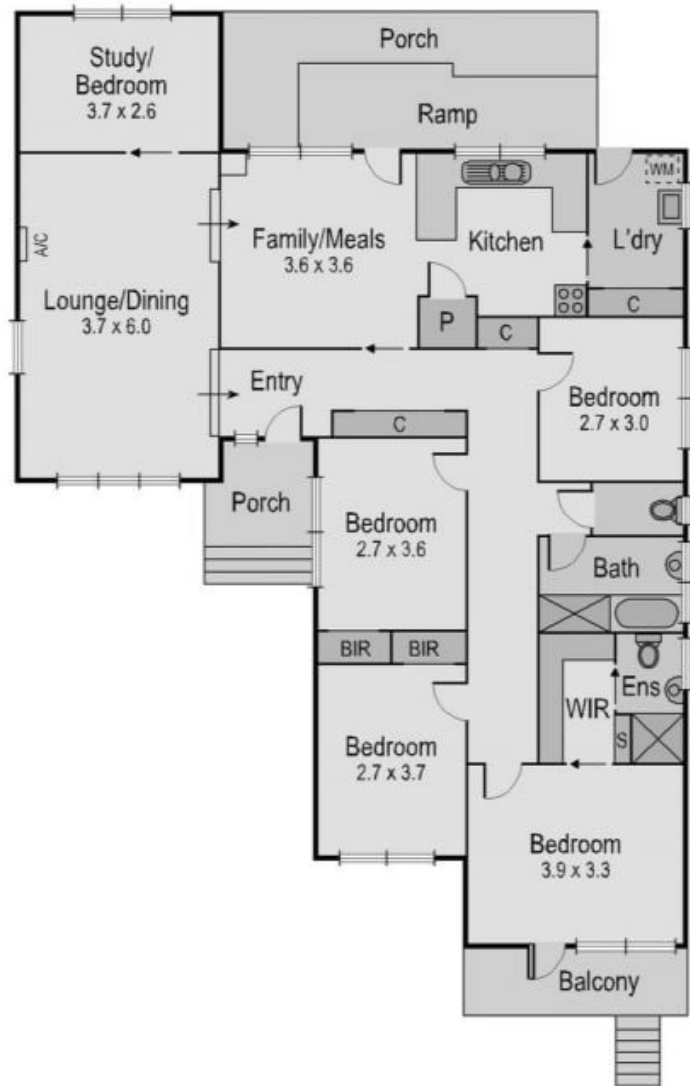
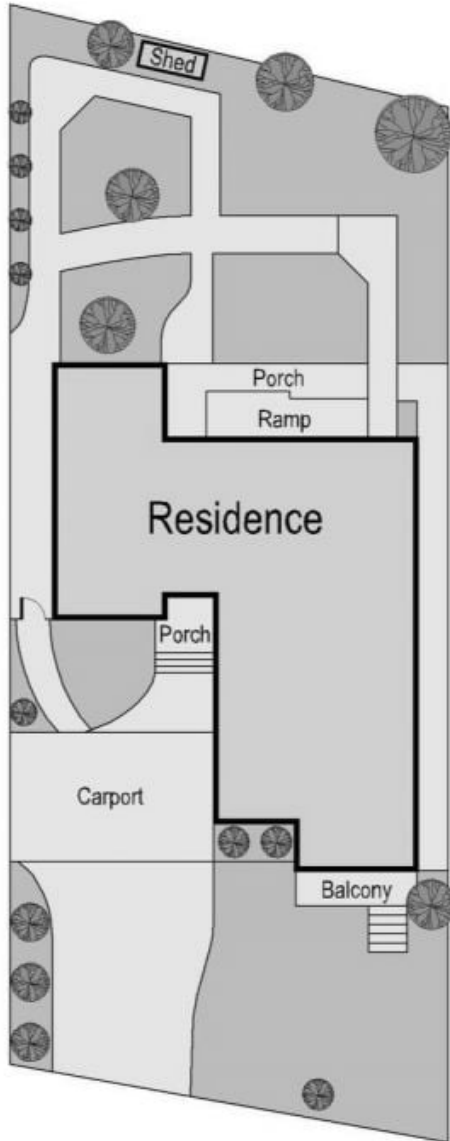

All stated dimensions and areas are approximate.

Particulars herein are for information only and do not constitute any representation by the owner or agent.

