



35 Gloucester Street Reservoir, VIC



Captivating Californian With Family Sized Living

This three bedroom Californian Bungalow on a very generous allotment of 625m2 (approx.) has been extended to introduce a seamless flow for entertaining and endless indoor-outdoor family enjoyment.

Retaining a traditional floor plan at the front, it introduces enhancements of Baltic Pine, leadlight, decorative ceiling straps and deep cornice throughout three bedrooms and a tessellated tiled bathroom. Head out to the rear and you'll discover a formal dining area and a vast open plan living zone.

Wrapping around a kitchen with an abundance of storage options and plenty of bench space to match, it offers options to zone off into a variety of areas as desired. Sitting, lounging, studying, eating there's plenty of space for all. Step outdoors to a decked undercover entertainment zone in a deep yard that includes a separate studio/home office/workshop.



Love Preston

preston@lovere.com.au

35 Gloucester st. Reservoir

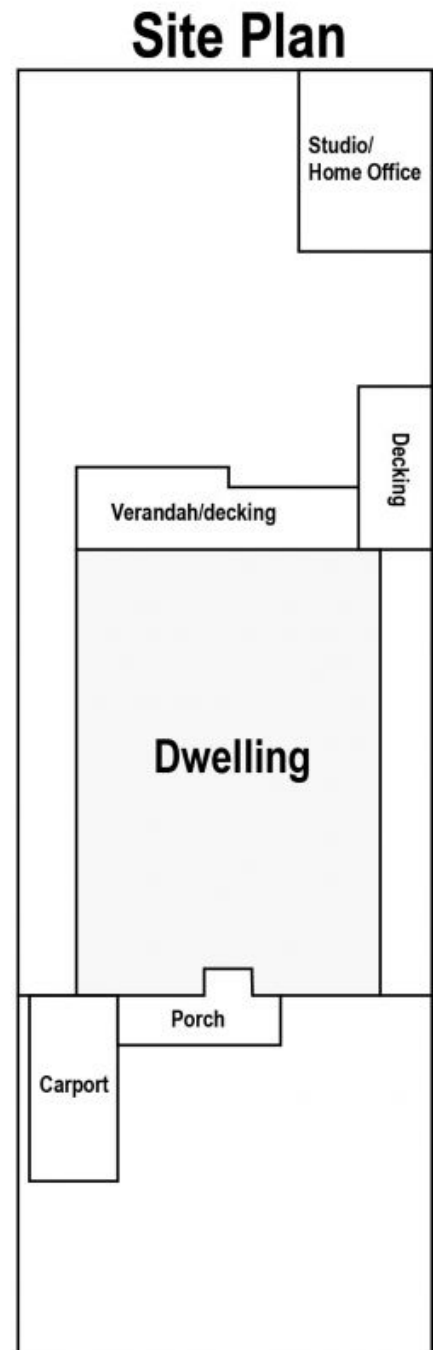
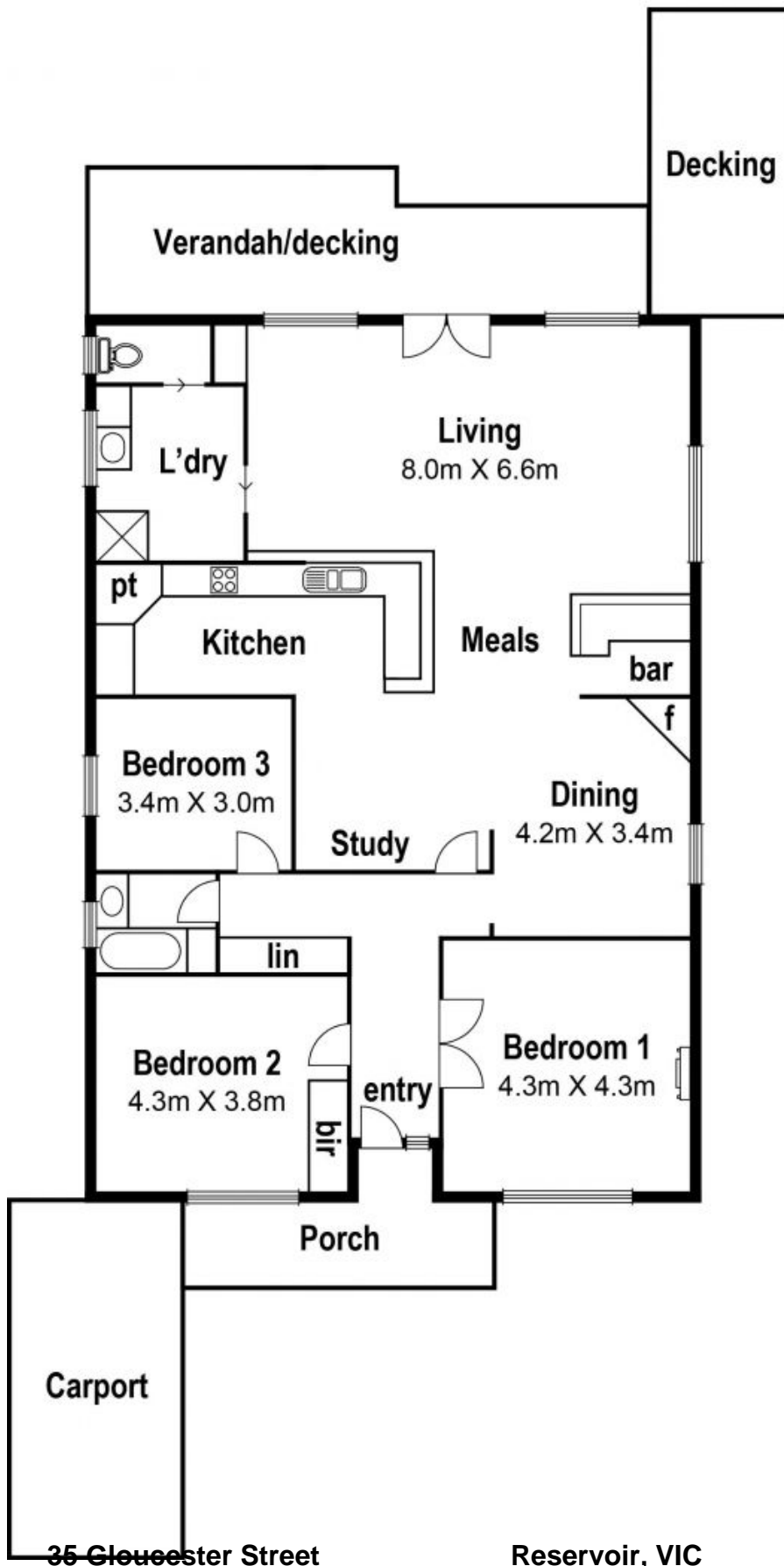

LOVE & CO

35 Gloucester Street

Reservoir, VIC