



1/30 Ruby Street Preston, VIC

2

1

1

### A REAL GEM OF A HOUSE ON RUBY STREET

Conveniently located within easy reach of Northland and closer still to the tram and shops on Plenty Road, this two bedroom home offers a fantastic entry to the market, as a nester or investor. Set on a corner allotment, it enjoys access from Ruby and Opal Streets and the easy care benefits of wrap around courtyards that provide parking and entertaining spaces with well established gardens. Polished timber floors, high ceilings and decorative cornice add character to both bedrooms, formal living, meals area and updated kitchen with stainless steel range. Period style exposed tap work to the shower and bath is a welcome feature in the family bathroom. Ducted heating, evaporative cooling, water tank for the free standing veggie garden and a very handy shed ensure this gem won't last long. Inspect Today! LOVE REAL ESTATE - NO 1 FOR PROPERTY MANAGEMENT \*\*INSPECTION BY APPOINTMENT ONLY - REGISTER YOUR INTEREST\*\* Please note that all inspection times are subject to change.

**Price:** \$350 per week



**Love Preston**

preston@lovere.com.au

# 1/30 Ruby St. Preston

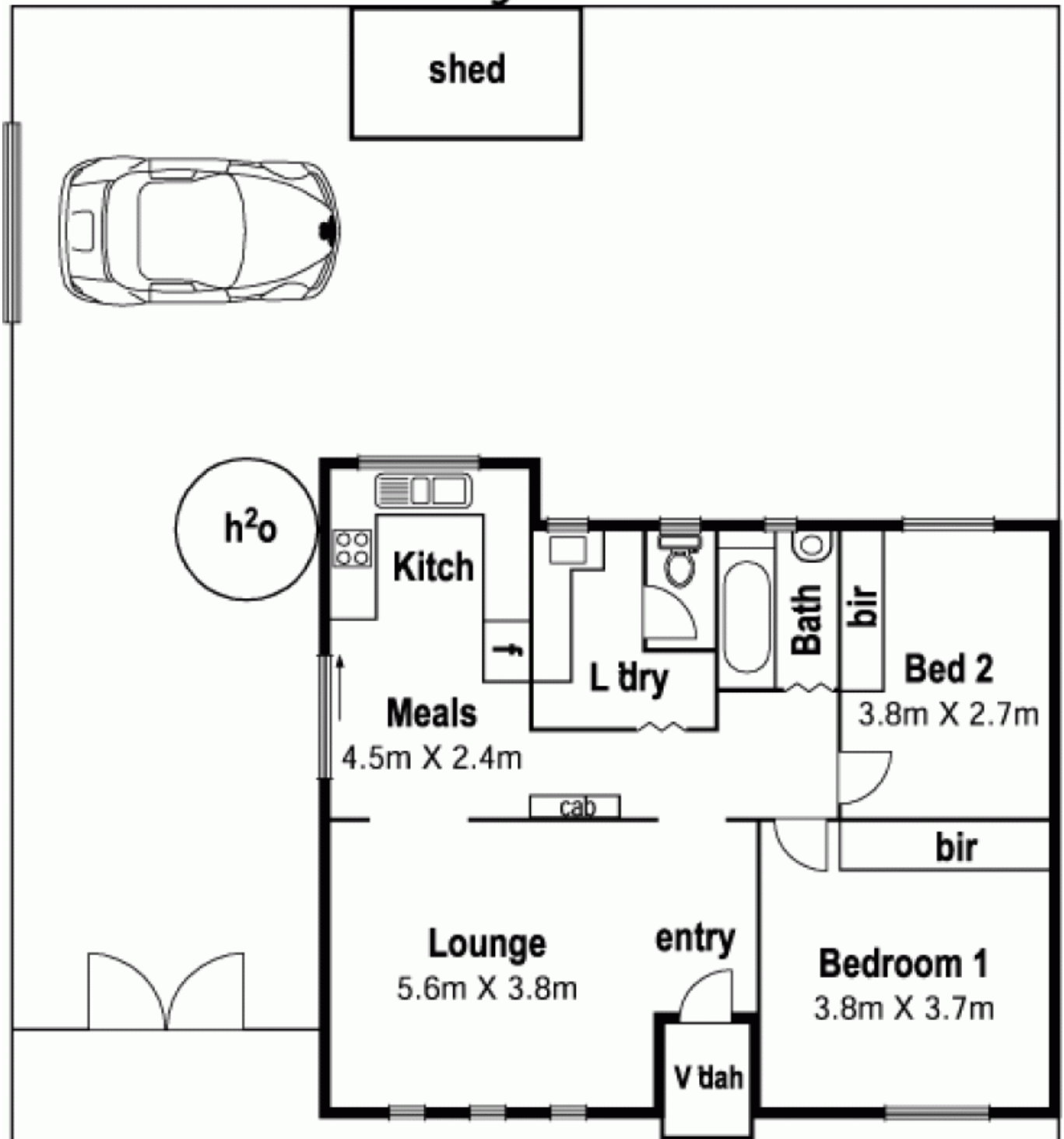

LOVE & CO

1/30 Ruby Street

Preston, VIC